

BORE GAGE

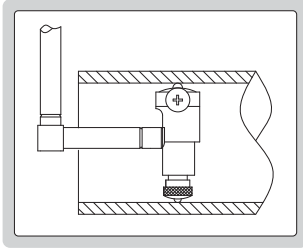

2827-160A

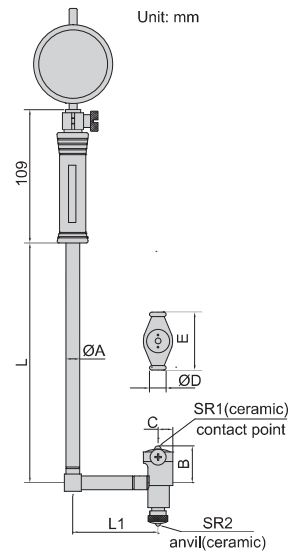

- Optional accessory: setting ring (code 6312)

Code	Range	Indicator	Accuracy	Repeatability
2827-160A	50-160mm	dial indicator code 2308-10FA	$\pm 0.018\text{mm}$	0.003mm
2827-250A	160-250mm	range 10mm, graduation 0.01mm	$\pm 0.018\text{mm}$	0.003mm
2827-450A	250-450mm		$\pm 0.018\text{mm}$	0.003mm

(mm)							
Range	$\varnothing A$	B	C	$\varnothing D$	E	L	L1
50-160mm	12.8	28.5	9.2	13	35	141	76.2
160-250mm	14.5	62.0	12.7	13	74.5	391	100
250-450mm	14.5	91.5	15.0	15	101.5	391	100

BORE GAGE



2828-800A

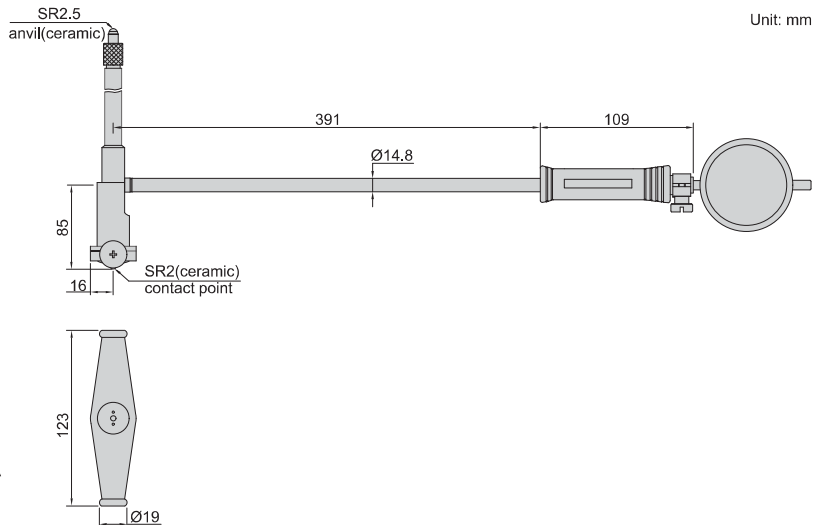

Code	Range	Indicator	Accuracy	Repeatability
2828-800A	400-800mm	dial indicator code 2308-10FA range 10mm, graduation 0.01mm	$\pm 0.025\text{mm}$	0.003mm

LONG HANDLE

- To assist deep-hole measurement
- Can be used for bore gages **2322** and **2122**

Code	Applicable bore gages	A	ØD
7351-EX11	35-60mm, 50-100mm,	475	13
7351-EX12	50-160mm, 100-160mm	980	13
7351-EX21	160-250mm, 250-450mm	480	14,5
7351-EX22		980	14,5

(mm)



7351-EX11

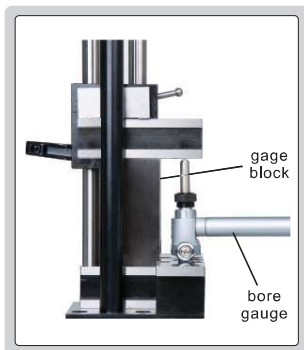
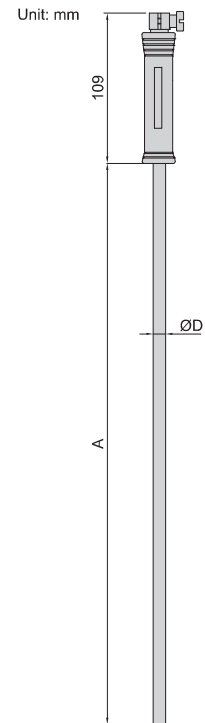

- Used together with gauge blocks to set bore gages

Code	Setting range
2395-400	18-400mm



2395-400

BORE GAGE SETTER

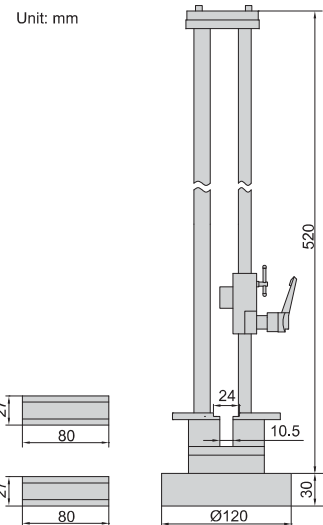

ANVIL FOR BORE GAGES



- For 2852, 2152, 2853, 2153, 2322, 2122, 2825, 2126, 2824, 2125, 2827, 2829, 2127, 2129

Code	Applicable bore gauges	Material of measuring face	Quantity per set	Measuring range of anvil (mm)
7350-10	6-10mm	steel	9pcs	6, 6.5, 7, 7.5, 8, 8.5, 9, 9.5, 10
7350-18	10-18.5mm	ceramic	9pcs	10, 11, 12, 13, 14, 15, 16, 17, 18
7350-35	18-35mm	ceramic	9pcs	18, 20, 22, 24, 26, 28, 30, 32, 34
7350-60	35-60mm	ceramic	6pcs	35, 40, 45, 50, 55, 60
7350-100	50-100mm	ceramic	11pcs	50, 55, 60, 65, 70, 75, 80, 85, 90, 95, 100
7350-160	50-160mm	ceramic	12pcs	50, 55, 60, 65, 70, 75, 80, 85, 90, 95, 100, 105
7350-161	100-160mm	ceramic	12pcs	50, 55, 60, 65, 70, 75, 80, 85, 90, 95, 100, 105
7350-250	160-250mm	ceramic	5pcs	160, 170, 180, 190, 200
7350-450	250-450mm	ceramic	5pcs	250, 260, 270, 280, 290

- For zero setting of inside micrometers, three points internal micrometers and bore gauges
- Deviation (difference between the ordered size and the size marked on the setting ring when supplied):
 - Ø3-100mm: ±3µm
 - Ø100-300mm: ±5µm
 For example, the ordered size is Ø10.125mm, the size marked on the setting ring when supplied may be Ø10.128mm
- Accuracy (the accuracy of the size marked on the setting ring, which is checked on direction of the marking line):
 - Ø3-100mm: ±1µm
 - Ø100-250mm: ±2µm
 - Ø250-300mm: ±2.5µm
- Cylindricity:
 - Ø3-100mm: ±1µm
 - Ø100-250mm: ±2µm
 - Ø250-300mm: ±2.5µm

CAN SUPPLY CUSTOM SETTING RING FROM Ø3.000MM TO Ø300.000MM, FOR EXAMPLE, Ø17.085MM

SETTING RING



Code	Nominal Size	Code	Nominal Size	Code	Nominal Size	Code	Nominal Size	Code	Nominal Size
6312-3*	Ø3mm	6312-17*	Ø17mm	6312-31*	Ø31mm	6312-45*	Ø45mm	6312-87*	Ø87mm
6312-4*	Ø4mm	6312-18*	Ø18mm	6312-32*	Ø32mm	6312-46*	Ø46mm	6312-90*	Ø90mm
6312-5*	Ø5mm	6312-19*	Ø19mm	6312-33*	Ø33mm	6312-47*	Ø47mm	6312-95*	Ø95mm
6312-6*	Ø6mm	6312-20*	Ø20mm	6312-34*	Ø34mm	6312-48*	Ø48mm	6312-100*	Ø100mm
6312-7*	Ø7mm	6312-21*	Ø21mm	6312-35*	Ø35mm	6312-49*	Ø49mm	6312-125*	Ø125mm
6312-8*	Ø8mm	6312-22*	Ø22mm	6312-36*	Ø36mm	6312-50*	Ø50mm	6312-150*	Ø150mm
6312-9*	Ø9mm	6312-23*	Ø23mm	6312-37*	Ø37mm	6312-55*	Ø55mm	6312-175*	Ø175mm
6312-10*	Ø10mm	6312-24*	Ø24mm	6312-38*	Ø38mm	6312-60*	Ø60mm	6312-200*	Ø200mm
6312-11*	Ø11mm	6312-25*	Ø25mm	6312-39*	Ø39mm	6312-62*	Ø62mm	6312-225*	Ø225mm
6312-12*	Ø12mm	6312-26*	Ø26mm	6312-40*	Ø40mm	6312-65*	Ø65mm	6312-250*	Ø250mm
6312-13*	Ø13mm	6312-27*	Ø27mm	6312-41*	Ø41mm	6312-70*	Ø70mm	6312-275*	Ø275mm
6312-14*	Ø14mm	6312-28*	Ø28mm	6312-42*	Ø42mm	6312-75*	Ø75mm	6312-300*	Ø300mm
6312-15*	Ø15mm	6312-29*	Ø29mm	6312-43*	Ø43mm	6312-80*	Ø80mm		
6312-16*	Ø16mm	6312-30*	Ø30mm	6312-44*	Ø44mm	6312-85*	Ø85mm		

* Supplied with manufacturer calibration certificate



INTERNAL CHAMFER GAGE



2941-20

- Measure end diameter of chamfer or taper holes
- Graduation: 0.01mm
- With limit pointers

Code	Range
2941-20	0.5-20.1mm
2941-40	20-40mm

measure end diameter of chamfer or taper holes

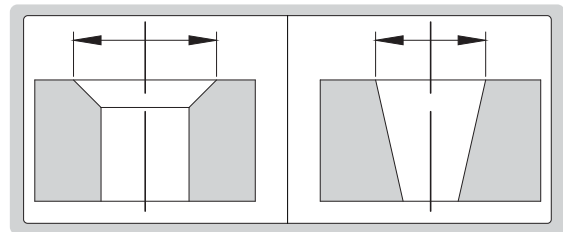

SMALL HOLE GAGE SET



4208-1

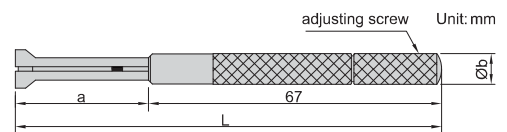

- 4 gages per set
- For small holes, slots and grooves, etc.
- Satin chrome finish

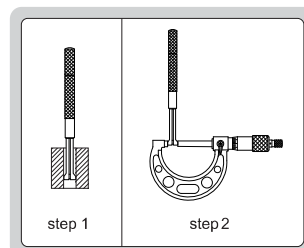

Code	Total range	Gages included
4208-1	3-13mm	3-5mm, 5-7.5mm 7.5-10mm, 10-13mm

Range	L	a	Øb
3-5mm	90	22.5	5.5
5-7.5mm	97.6	30	5.5
7.5-10mm	102.8	35	8.5
10-13mm	108	40	8.5

TELESCOPING GAGE SET

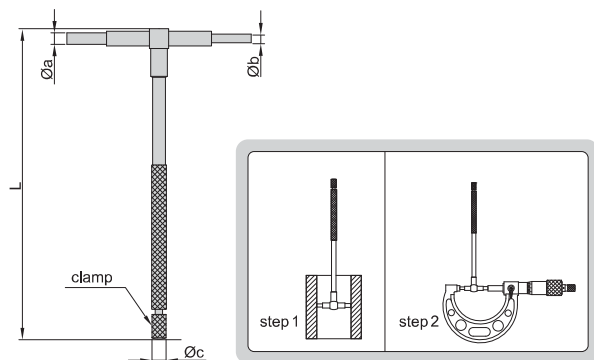

4206-1

Range	L	Øa	Øb	Øc
8-12.7mm	115	3.9	2.9	6.2
12.7-19mm	115	5.3	3.8	6.2
19-32mm	115	5.3	3.8	6.2
32-54mm	137	7.6	6.1	7.2
54-90mm	137	7.6	6.1	7.2
90-150mm	137	7.6	6.1	7.2

Code	Total range	Gages included
4206-1	8-150mm	8-12.7mm, 12.7-19mm 19-32mm, 32-54mm 54-90mm, 90-150mm

- 6 gages per set
- For quick measurement of inside diameter of holes and width of slots
- Satin chrome finish

LONG HANDLE TELESCOPING GAGE

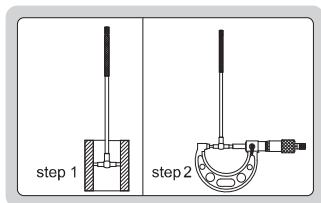

- For quick measurement of inside diameter of deep holes and width of slots
- Satin chrome finish

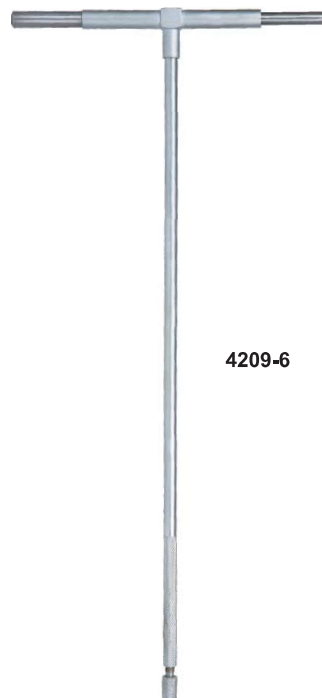

4209-6

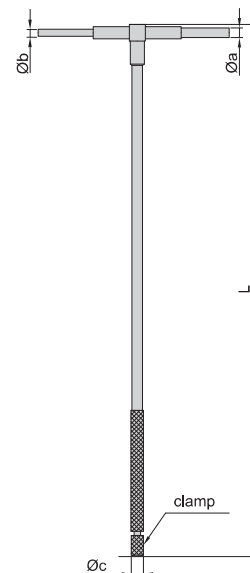

Code	Range	L	Øa	Øb	Øc
4209-1	8-12.7mm	250	3.9	2.9	6.2
4209-2	12.7-19mm	250	5.3	3.8	6.2
4209-3	19-32mm	250	5.3	3.8	6.2
4209-4	32-54mm	300	7.6	6.1	7.2
4209-5	54-90mm	300	7.6	6.1	7.2
4209-6	90-150mm	300	7.6	6.1	7.2

LARGE DIAMETER GAGE CODE ISQ-RA500

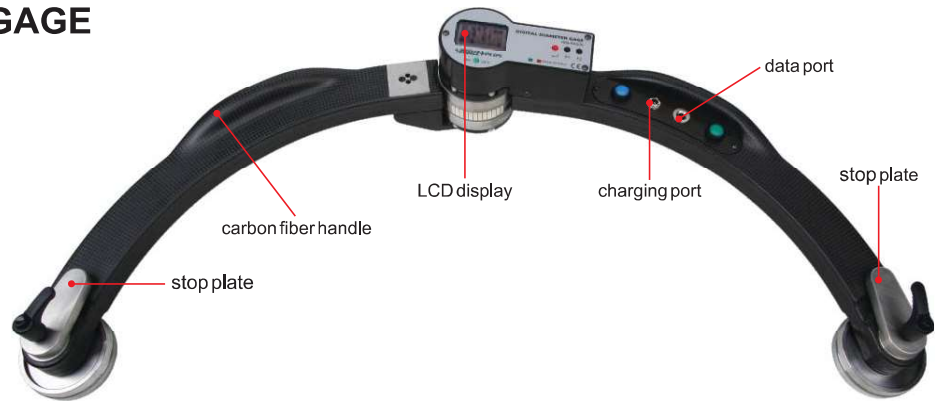

- To measure large external or internal diameters
- Automatic judgment and display external (EXT) or internal diameter (INT)
- Carbon fiber handle, light in weight
- Backlight LCD display, can rotate 180° for easy reading
- Memory of 10 readings and average calculation
- With minimum measurement mode (MIN)
- Angle can be displayed



external diameter measurement



internal diameter measurement

SPECIFICATION

Range	EXT	Ø500 ~ 6000mm
	INT	Ø1100 ~ 6000mm
Resolution	0.01mm	
Accuracy	±(0.02+0.1D²)mm (D is the diameter to be measured, in m)	
Power supply	rechargeable battery (for 6 hours working)	
Weight	3.8kg	

STANDARD DELIVERY

Main unit	1pc
AC/DC adapter	1pc
Cable and software	1pc

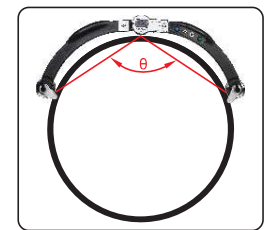

display of angle



2183

- Measure radius of internal and external arcs
- Supplied with 5 jaws for different sizes of arc
- Battery CR2032

Code	Range of radius (R)	Resolution	Accuracy (mm)
2183	5-700mm/0.2-27.5"	0.005mm/0.00005"	±0.01R*

* R is the radius to be measured

DIGITAL RADIUS GAGE

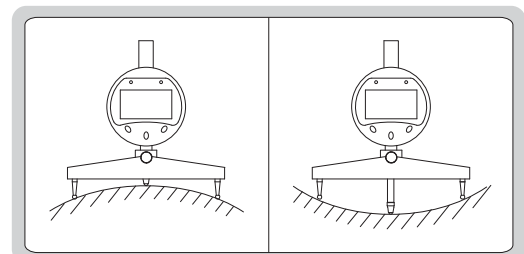
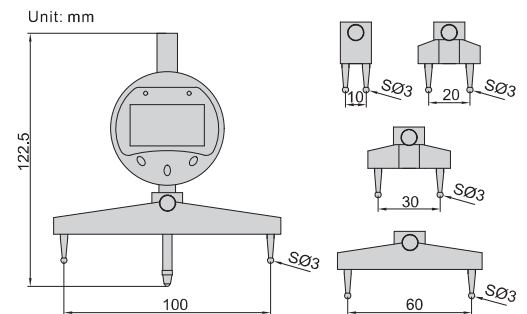

CIRCUMFERENCE TAPE



Unit: mm

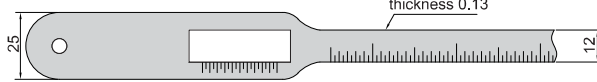

7116-115

- Measure diameter of cables, thin plastic pipes, etc., which may deform
- Laser engraved scale
- Made of stainless steel

Code	Diameter range	Graduation	Accuracy
7116-115	Ø20-115mm	0.05mm	±0.10mm
7116-230	Ø100-230mm	0.05mm	±0.10mm
7116-330	Ø200-330mm	0.05mm	±0.15mm
7116-620	Ø300-620mm	0.05mm	±0.20mm

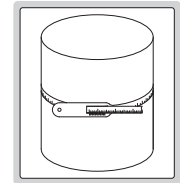

CIRCUMFERENCE TAPE



Unit: mm

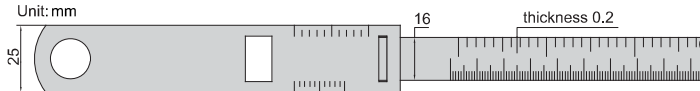

7115-3460

- Measure diameter and circumference of pipes, trees, tires, etc.
- Laser engraved scale
- Made of stainless steel

Code	Circumference range	Diameter range	Graduation	Accuracy	
				Circumference	Diameter
7115-950	150-950mm	Ø50-300mm	0.1mm	±0.50mm	±0.15mm
7115-2200	940-2200mm	Ø300-700mm	0.1mm	±0.60mm	±0.20mm
7115-3460	2190-3460mm	Ø700-1100mm	0.1mm	±0.60mm	±0.20mm
7115-4720	3450-4720mm	Ø1100-1500mm	0.1mm	±0.75mm	±0.25mm
7115-5980	4710-5980mm	Ø1500-1900mm	0.1mm	±0.90mm	±0.30mm

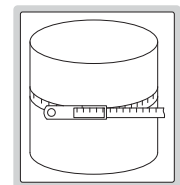

CIRCUMFERENCE TAPE

BASIC MODEL

Unit: mm

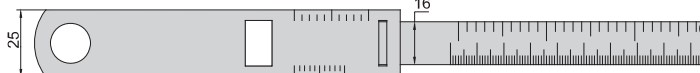

7114-950

- Measure diameter and circumference of pipes, trees, tires, etc.
- Laser engraved scale
- Made of stainless steel

Code	Circumference range	Diameter range	Graduation	Accuracy	
				Circumference	Diameter
7114-950	60-950mm	Ø20-300mm	0.1mm	±1.5mm	±0.5mm
7114-2200	940-2200mm	Ø300-700mm	0.1mm	±1.5mm	±0.5mm
7114-3460	2190-3460mm	Ø700-1100mm	0.1mm	±1.5mm	±0.5mm

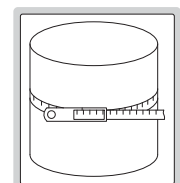

DATA
OUTPUT

DIGITAL INDICATOR



2103-10



2104-25



2103-50

Unit: mm

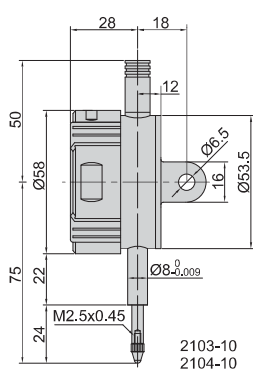

2103-10
2104-10

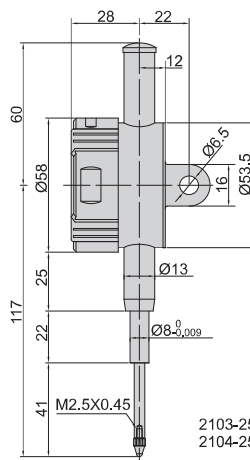

2103-25
2104-25

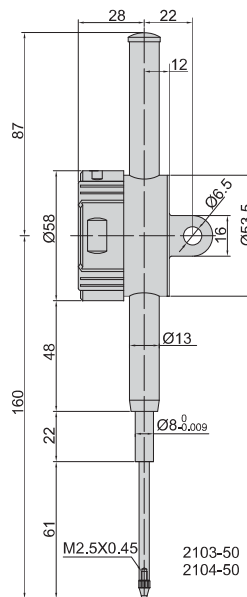

2103-50
2104-50

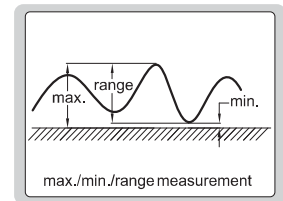

max./min./range measurement



display can be rotated by 320°

Resolution 0.001mm/0.00005"

Code	Range	Accuracy	Hysteresis	Remark
2103-10 *	12.7mm/0.5"	5µm	2µm	lug back
2103-25 *	25.4mm/1"	5µm	3µm	lug back
2103-50 *	50.8mm/2"	6µm	3µm	lug back
2103-10F *	12.7mm/0.5"	5µm	2µm	flat back
2103-25F *	25.4mm/1"	5µm	3µm	flat back
2103-50F *	50.8mm/2"	6µm	3µm	flat back

Resolution 0.01mm/0.0005"

Code	Range	Accuracy	Hysteresis	Remark
2104-10 *	12.7mm/0.5"	20µm	10µm	lug back
2104-25 *	25.4mm/1"	20µm	10µm	lug back
2104-50 *	50.8mm/2"	30µm	10µm	lug back
2104-10F *	12.7mm/0.5"	20µm	10µm	flat back
2104-25F *	25.4mm/1"	20µm	10µm	flat back
2104-50F *	50.8mm/2"	30µm	10µm	flat back

* Supplied with manufacturer calibration certificate

- Reading in digit and analog
- Display can be rotated by 320°
- Button function: tolerance Go and No-Go display, data preset, measuring direction change, max./min./range measurement, inch/metric conversion, absolute/incremental measurement
- CR2032 battery, automatic power off
- Data output
- Optional accessory: data output system, backs (page 132), contact points (page 128~131)

DIGITAL INDICATOR

DATA
OUTPUT



2112-10



2112-251



2112-501

Unit: mm

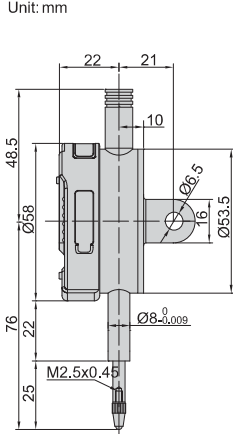

2112-10
2112-101

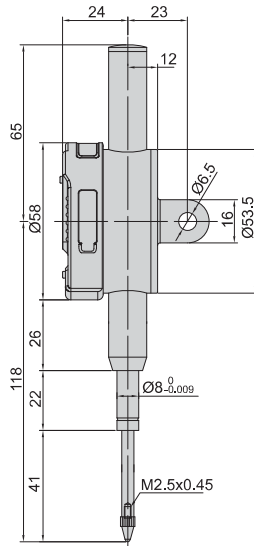

2112-25
2112-251

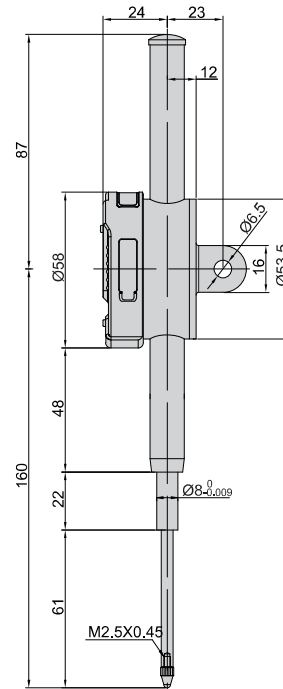

2112-50
2112-501

- Button function: on/off, inch/mm, zero
- CR2032 battery, automatic power off
- Data output
- Optional accessory: data output system, backs (page 132), contact points (page 128~131)

Resolution 0.001mm/0.00005"

Code	Range	Accuracy	Hysteresis	Remark
2112-101 *	12.7mm/0.5"	5µm	2µm	lug back
2112-251 *	25.4mm/1"	5µm	3µm	lug back
2112-501 *	50.8mm/2"	6µm	3µm	lug back
2112-101F *	12.7mm/0.5"	5µm	2µm	flat back
2112-251F *	25.4mm/1"	5µm	3µm	flat back
2112-501F *	50.8mm/2"	6µm	3µm	flat back

Resolution 0.01mm/0.0005"

Code	Range	Accuracy	Hysteresis	Remark
2112-10 *	12.7mm/0.5"	20µm	10µm	lug back
2112-25 *	25.4mm/1"	20µm	10µm	lug back
2112-50 *	50.8mm/2"	30µm	10µm	lug back
2112-10F *	12.7mm/0.5"	20µm	10µm	flat back
2112-25F *	25.4mm/1"	20µm	10µm	flat back
2112-50F *	50.8mm/2"	30µm	10µm	flat back

* Supplied with manufacturer calibration certificate

WATERPROOF DIGITAL INDICATOR

DATA OUTPUT

WATERPROOF



2115-10

2115-25

- Dust/waterproof
- Button function: on/off, zero, mm/inch
- CR2032 battery, automatic power off
- Data output
- Optional accessory: data output system, backs (page 132), contact points (page 128~131)

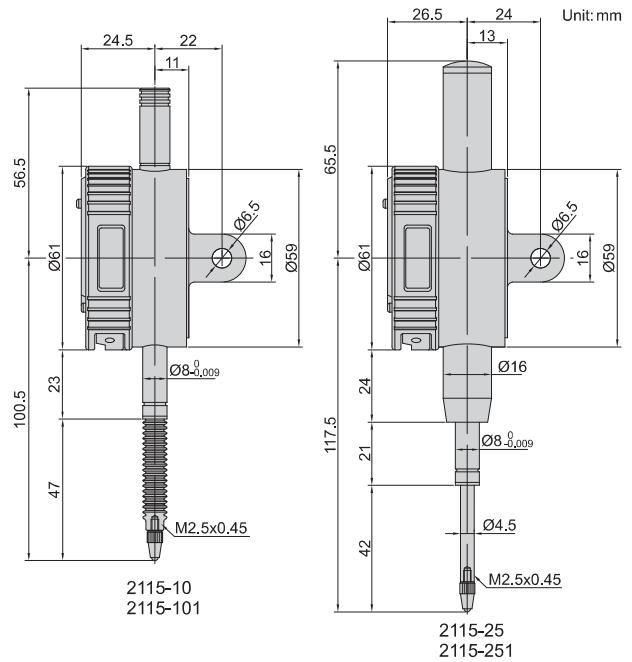

Resolution 0.001mm/0.00005"

Code	Range	Dust/waterproof	Accuracy	Hysteresis	Remark
2115-101*	12.7mm/0.5"	IP65	5µm	2µm	lug back
2115-251*	25.4mm/1"	IP54	5µm	3µm	lug back
2115-101F*	12.7mm/0.5"	IP65	5µm	2µm	flat back
2115-251F*	25.4mm/1"	IP54	5µm	3µm	flat back

Resolution 0.01mm/0.0005"

Code	Range	Dust/waterproof	Accuracy	Hysteresis	Remark
2115-10*	12.7mm/0.5"	IP65	20µm	10µm	lug back
2115-25*	25.4mm/1"	IP54	20µm	10µm	lug back
2115-10F*	12.7mm/0.5"	IP65	20µm	10µm	flat back
2115-25F*	25.4mm/1"	IP54	20µm	10µm	flat back

* Supplied with manufacturer calibration certificate

DIGITAL INDICATOR WITH LIFTING LEVER

- Reading in digit and analog
- Display can be rotated by 320°
- Button function: tolerance Go and No-Go display, data preset, measuring direction change, max./min./range measurement, inch/metric conversion, absolute/incremental measurement
- CR2032 battery, automatic power off
- Data output
- Optional accessory: data output system, backs (page 132), contact points (page 128~131)

Code	Range	Resolution	Accuracy	Hysteresis	Remark
2109-10*	10mm/0.4"	0.01mm/0.0005"	20µm	10µm	flat back
2109-101*	10mm/0.4"	0.001mm/0.00005"	5µm	2µm	flat back

* Supplied with manufacturer calibration certificate

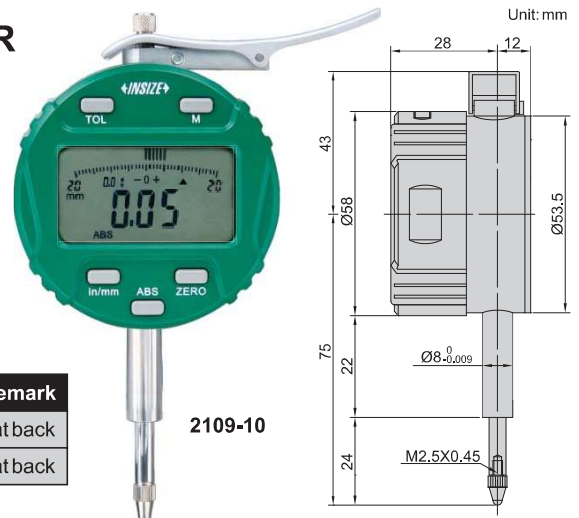

2109-10

DATA OUTPUT

NO AUTO POWER OFF DIGITAL INDICATOR



2113-10



2113-251

- No auto power off, tracking the deformation of mould and steel structure for a long time
- Low power consumption
- Button function: on/off, zero, inch/mm
- CR2032 battery
- Data output
- Optional accessory: data output cable (code 7305-SPC1A)
- Optional accessory: backs (page 132), contact points (page 128~131)

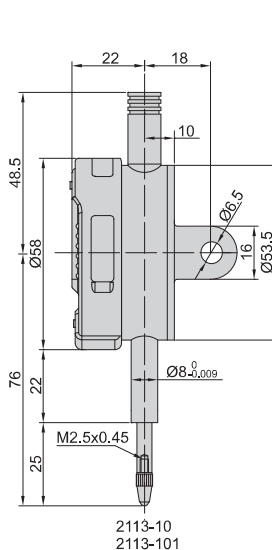

2113-10
2113-101

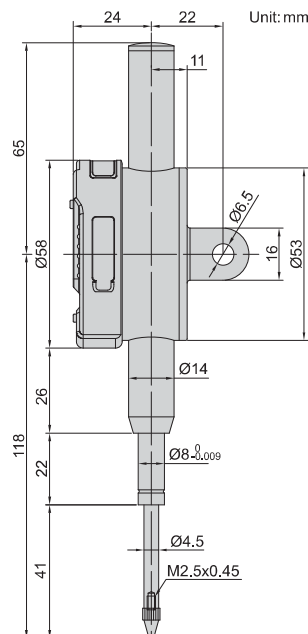

2113-25
2113-251

data output cable (optional)



Resolution 0.001mm/0.00005"

Code	Range	Accuracy	Hysteresis	Remark
2113-101*	12.7mm/0.5"	5µm	2µm	lug back
2113-251*	25.4mm/1"	5µm	3µm	lug back
2113-101F*	12.7mm/0.5"	5µm	2µm	flat back
2113-251F*	25.4mm/1"	5µm	3µm	flat back

* Supplied with manufacturer calibration certificate

Resolution 0.01mm/0.0005"

Code	Range	Accuracy	Hysteresis	Remark
2113-10*	12.7mm/0.5"	20µm	10µm	lug back
2113-25*	25.4mm/1"	20µm	10µm	lug back
2113-10F*	12.7mm/0.5"	20µm	10µm	flat back
2113-25F*	25.4mm/1"	20µm	10µm	flat back

DIGITAL INDICATOR FOR BORE GAGES

- Specially designed for bore gages
- The minimum value tracking function can find the diameter automatically
- Read the diameter directly, after inputting the size of setting ring
- Reading in digit and analog
- Display can be rotated by 320°
- Button function: minimum value tracking, calibration, data preset, inch/metric conversion, absolute/incremental measurement
- CR2032 battery, automatic power off
- Data output
- Optional accessory: data output system, backs (page 132), contact points (page 128~131)



2108-10F

DATA OUTPUT

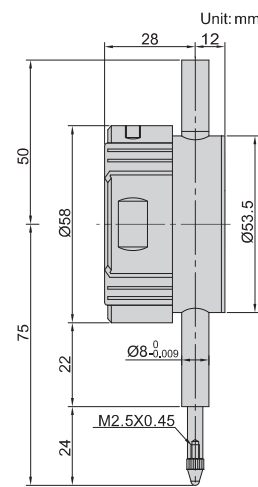

Code	Range	Resolution	Accuracy	Hysteresis	Remark
2108-10F*	12.7mm/0.5"	0.002mm/0.0001"	20µm	10µm	flat back
2108-101F*	12.7mm/0.5"	0.001mm/0.00005"	5µm	2µm	flat back

* Supplied with manufacturer calibration certificate

DIAL COMPARATOR

JEWELLED BEARING

SHOCK PROOF

- Shockproof
- Jeweled bearing
- Overtravel: 3mm
- Shadow free dial face cover
- Supplied with limit pointers
- Initial measuring force 1.2N
- Optional accessory: lifting lever (code 6289-150)



2881-01

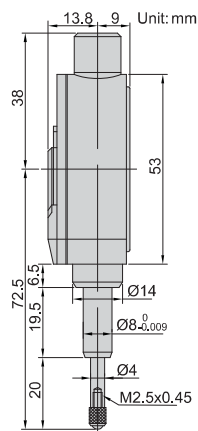

lifting lever (optional)



lever construction

within the measuring range, the spindle is in contact with the lever



when the measuring range is exceeded, the spindle leaves the lever



Code	Range	Graduation	Accuracy	Hysteresis	Dial reading	Remark
2881-01 *	0.1mm	0.001mm	1.2µm	0.5µm	50-0-50	flat back

* Supplied with manufacturer calibration certificate

PRECISION DIAL INDICATOR

JEWELLED BEARING

- Jeweled bearing
- With limit pointers
- Optional accessory: backs (page 132), contact points (page 128~131)



2830-1

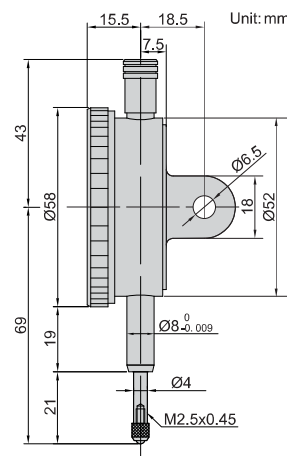

Code	Range	Graduation	Accuracy	Hysteresis	Range/rev	Dial reading	Remark
2830-1 *	1mm	0.001mm	4µm	2µm	0.2mm	0-100-0	lug back
2830-1F *	1mm	0.001mm	4µm	2µm	0.2mm	0-100-0	flat back

* Supplied with manufacturer calibration certificate

PRECISION DIAL INDICATOR

JEWELLED BEARING

- Graduation: 0.001mm
- Jeweled bearing
- Supplied with limit pointers
- Optional accessory: backs (page 132), contact points (page 128~131)



2313-1A

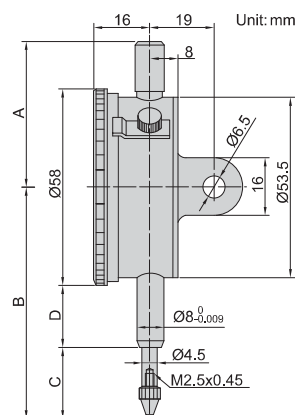

Code	Range	Accuracy	Hysteresis	Range/rev	Dial reading	Remark	A	B	C	D
2313-1A *	1mm	5µm	2µm	0.2mm	0-100-0	lug back	45	62.5	19.5	15
2313-2A *	2mm	8µm	2.5µm	0.2mm	0-100-0	lug back	45	62.5	19.5	15
2313-1FA *	1mm	5µm	2µm	0.2mm	0-100-0	flat back	45	62.5	19.5	15
2313-2FA *	2mm	8µm	2.5µm	0.2mm	0-100-0	flat back	45	62.5	19.5	15

* Supplied with manufacturer calibration certificate

COMPACT DIAL INDICATOR



2886-3

- With limit pointers
- Optional accessory: backs (page 132), contact points (page 128~131)

Code	Range	Graduation	Accuracy	Hysteresis	Range/rev	Dial reading	Remark
2886-3 *	3mm	0.01mm	12μm	3μm	0.5mm	0-50	lug back
2886-3F *	3mm	0.01mm	12μm	3μm	0.5mm	0-50	flat back

* Supplied with manufacturer calibration certificate

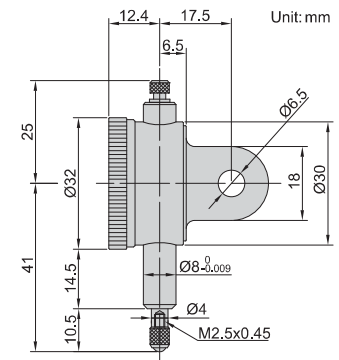

COMPACT DIAL INDICATOR



2887-5

- With limit pointers
- Optional accessory: backs (page 132), contact points (page 128~131)

Code	Range	Graduation	Accuracy	Hysteresis	Range/rev	Dial reading	Remark
2887-5 *	5mm	0.01mm	14μm	3μm	0.5mm	0-50	lug back
2887-5F *	5mm	0.01mm	14μm	3μm	0.5mm	0-50	flat back

* Supplied with manufacturer calibration certificate

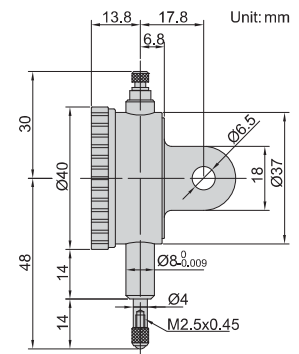

COMPACT DIAL INDICATOR



2311-5

- Jeweled bearing
- Supplied with limit pointers
- Optional accessory: backs (page 132), contact points (page 128~131)

Code	Range	Graduation	Accuracy	Hysteresis	Range/rev	Dial reading	Remark	B	D
2311-3 *	3mm	0.01mm	14μm	3μm	0.5mm	0-50	lug back	46	10.5
2311-5 *	5mm	0.01mm	16μm	3μm	0.5mm	0-50	lug back	48	12.5
2311-3F *	3mm	0.01mm	14μm	3μm	0.5mm	0-50	flat back	46	10.5
2311-5F *	5mm	0.01mm	16μm	3μm	0.5mm	0-50	flat back	48	12.5

* Supplied with manufacturer calibration certificate

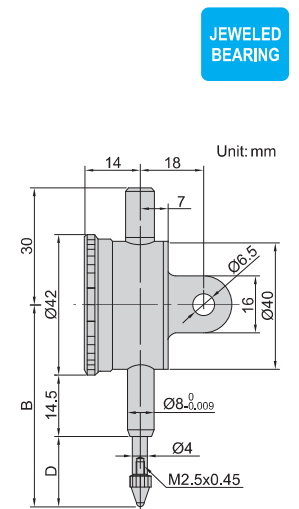



DIAL INDICATOR



2892-10

- With limit pointers
- Optional accessory: backs (page 132), contact points (page 128~131)

Code	Range	Graduation	Accuracy	Hysteresis	Range/rev	Dial reading	Remark
2892-10 *	10mm	0.01mm	17μm	3μm	1mm	0-100	lug back
2892-10F *	10mm	0.01mm	17μm	3μm	1mm	0-100	flat back

* Supplied with manufacturer calibration certificate

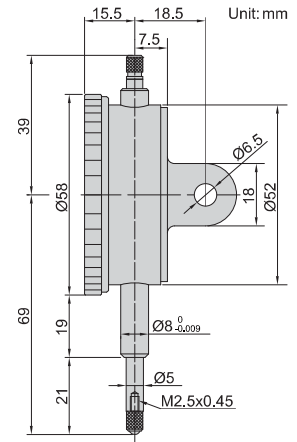

JEWELLED BEARING

DIAL INDICATOR



2308-10A

- Jeweled bearing
- Supplied with limit pointers and bezel clamp
- Optional accessory: backs (page 132), contact points (page 128~131)

Code	Range	Graduation	Accuracy	Hysteresis	Range/rev	Dial reading	Remark
2308-3A *	3mm	0.01mm	14μm	3μm	1mm	0-100	lug back
2308-5A *	5mm	0.01mm	16μm	3μm	1mm	0-100	lug back
2308-10A *	10mm	0.01mm	17μm	3μm	1mm	0-100	lug back
2308-3FA *	3mm	0.01mm	14μm	3μm	1mm	0-100	flat back
2308-5FA *	5mm	0.01mm	16μm	3μm	1mm	0-100	flat back
2308-10FA *	10mm	0.01mm	17μm	3μm	1mm	0-100	flat back

* Supplied with manufacturer calibration certificate

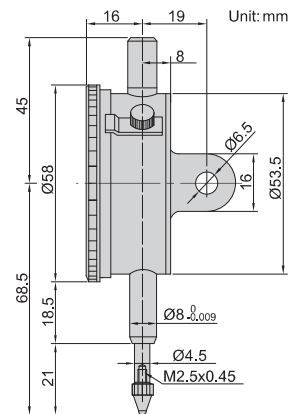

SHOCKPROOF DIAL INDICATOR



SHOCK PROOF



2883-10

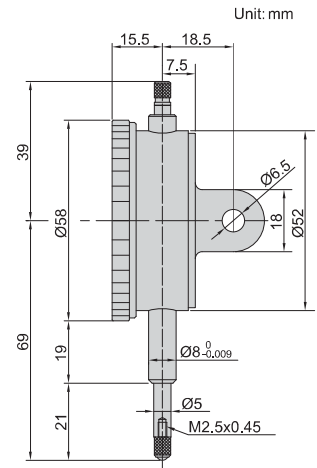

- Shockproof
- With limit pointers
- Optional accessory: backs (page 132), contact points (page 128~131)

Code	Range	Graduation	Accuracy	Hysteresis	Range/rev	Dial reading	Remark
2883-10*	10mm	0.01mm	17µm	3µm	1mm	0-100	lug back
2883-10F*	10mm	0.01mm	17µm	3µm	1mm	0-100	flat back

* Supplied with manufacturer calibration certificate

SHOCKPROOF DIAL INDICATOR

SHOCK PROOF

JEWELLED BEARING



2314-10A

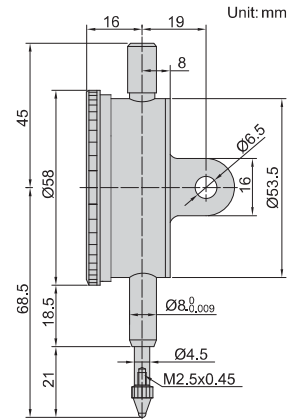

- Shockproof
- Jeweled bearing
- Supplied with limit pointers and bezel clamp
- Optional accessory: backs (page 132), contact points (page 128~131)

Code	Range	Graduation	Accuracy	Hysteresis	Range/rev	Dial reading	Remark
2314-3A*	3mm	0.01mm	14µm	3µm	1mm	0-100	lug back
2314-5A*	5mm	0.01mm	16µm	3µm	1mm	0-100	lug back
2314-10A*	10mm	0.01mm	20µm	3µm	1mm	0-100	lug back
2314-3FA*	3mm	0.01mm	14µm	3µm	1mm	0-100	flat back
2314-5FA*	5mm	0.01mm	16µm	3µm	1mm	0-100	flat back
2314-10FA*	10mm	0.01mm	20µm	3µm	1mm	0-100	flat back

* Supplied with manufacturer calibration certificate



IP67
WATERPROOF

SHOCK
PROOF

WATERPROOF DIAL INDICATOR



2894-10F

- Shockproof
- IP67 dust/waterproof
- Optional accessory:
contact points (page 128~131)

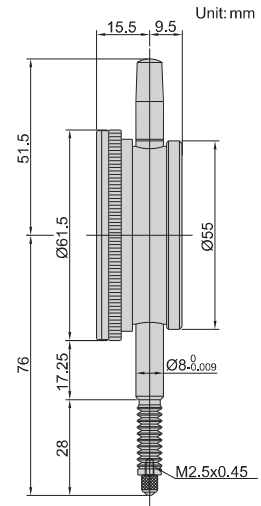

Code	Range	Graduation	Accuracy	Hysteresis	Range/rev	Dial reading	Remark
2894-10F*	10mm	0.01mm	17µm	3µm	1mm	0-100	flat back

* Supplied with manufacturer calibration certificate

IP54
WATERPROOF

JEWELLED
BEARING

WATERPROOF DIAL INDICATOR



2324-10

- IP54 dust/waterproof
- Jeweled bearing

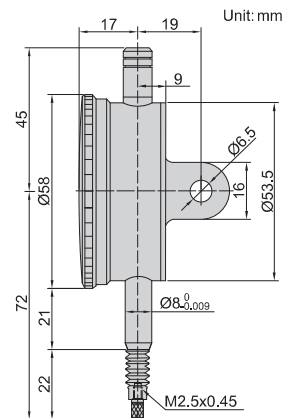

Code	Range	Graduation	Accuracy	Hysteresis	Range/rev	Dial reading	Remark
2324-10*	10mm	0.01mm	17µm	3µm	1mm	0-100	lug back
2324-10F*	10mm	0.01mm	17µm	3µm	1mm	0-100	flat back

* Supplied with manufacturer calibration certificate

BACK PLUNGER TYPE DIAL INDICATOR



2893-3

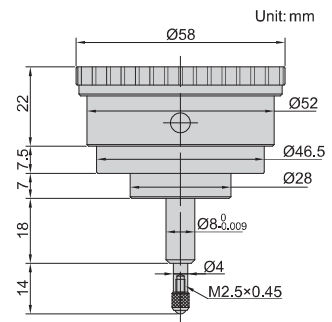

- Supplied with limit pointers
- Optional accessory: contact points (page 128~131)

Code	Range	Graduation	Accuracy	Hysteresis	Range/rev	Dial reading
2893-3 *	3mm	0.01mm	15µm	5µm	1mm	0-100

* Supplied with manufacturer calibration certificate

LARGE DIAL FACE DIAL INDICATOR



2888-10

- Large, easy-to-read dial face
- With limit pointers
- Optional accessory: backs (page 132), contact points (page 128~131)

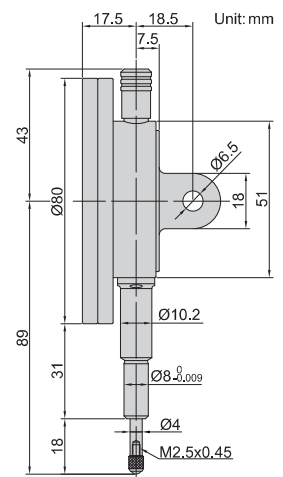

Code	Range	Graduation	Accuracy	Hysteresis	Range/rev	Dial reading	Remark
2888-10 *	10mm	0.01mm	17µm	5µm	1mm	0-100	flat back, with spare lug back

* Supplied with manufacturer calibration certificate

JEWELLED BEARING

DIAL INDICATOR WITH LIFTING LEVER



2329-10

- Jeweled bearing
- Supplied with limit pointers
- Optional accessory: backs (page 132), contact points (page 128~131)

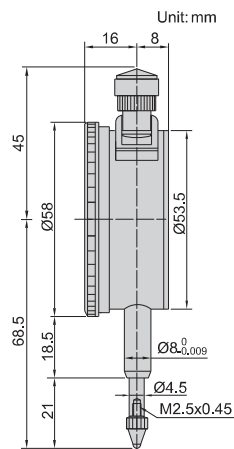

Code	Range	Graduation	Accuracy	Hysteresis	Range/rev	Dial reading	Remark
2329-10	10mm	0.01mm	20µm	3µm	1mm	0-100	flat back



2318-30

- Supplied with limit pointers and bezel clamp
- Optional accessory: backs (page 132), contact points (page 128~131)

DIAL INDICATOR

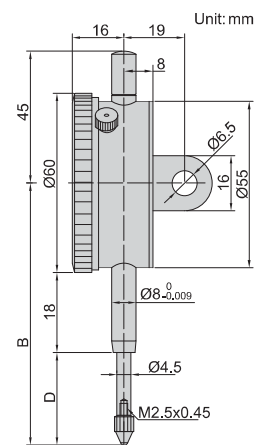

(mm)

Code	Range	Graduation	Accuracy	Hysteresis	Range/rev	Dial reading	Remark	B	D
2318-10	10mm	0.1mm	40µm	20µm	10mm	0-10	lug back	70	20
2318-20	20mm	0.1mm	50µm	20µm	10mm	0-10	lug back	85	35
2318-25	25mm	0.1mm	60µm	20µm	10mm	0-10	lug back	85	35
2318-30	30mm	0.1mm	60µm	20µm	10mm	0-10	lug back	90	40
2318-10F	10mm	0.1mm	40µm	20µm	10mm	0-10	flat back	70	20
2318-20F	20mm	0.1mm	50µm	20µm	10mm	0-10	flat back	85	35
2318-25F	25mm	0.1mm	60µm	20µm	10mm	0-10	flat back	85	35
2318-30F	30mm	0.1mm	60µm	20µm	10mm	0-10	flat back	90	40

DIAL INDICATOR



2889-30

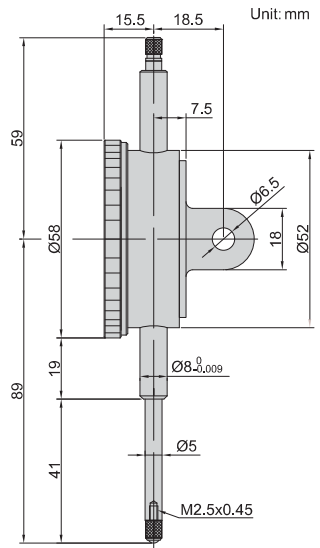

- With limit pointers
- Optional accessory: backs (page 132), contact points (page 128~131)

Code	Range	Graduation	Accuracy	Hysteresis	Range/rev	Dial reading	Remark
2889-30*	30mm	0.01mm	25µm	5µm	1mm	0-100	lug back
2889-30F*	30mm	0.01mm	25µm	5µm	1mm	0-100	flat back

* Supplied with manufacturer calibration certificate

DIAL INDICATOR



2310-30A

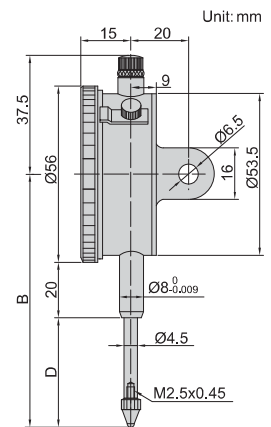

- Supplied with limit pointers and bezel clamp
- Optional accessory: backs (page 132), contact points (page 128~131)

Code	Range	Graduation	Accuracy	Hysteresis	Range/rev	Dial reading	Remark	B	D
2310-20A*	20mm	0.01mm	25µm	5µm	1mm	0-100	lug back	83mm	35mm
2310-30A*	30mm	0.01mm	35µm	7µm	1mm	0-100	lug back	88mm	40mm
2310-20FA*	20mm	0.01mm	25µm	5µm	1mm	0-100	flat back	83mm	35mm
2310-30FA*	30mm	0.01mm	35µm	7µm	1mm	0-100	flat back	88mm	40mm

* Supplied with manufacturer calibration certificate

JEWELLED BEARING

SHOCK PROOF

DIAL INDICATOR



2309-50

- Shockproof
- Jeweled bearing
- Supplied with limit pointers
- Optional accessory: backs (page 132), contact points (page 128~131)

back of type B



stem clamp Ø10mm for 2309-100D

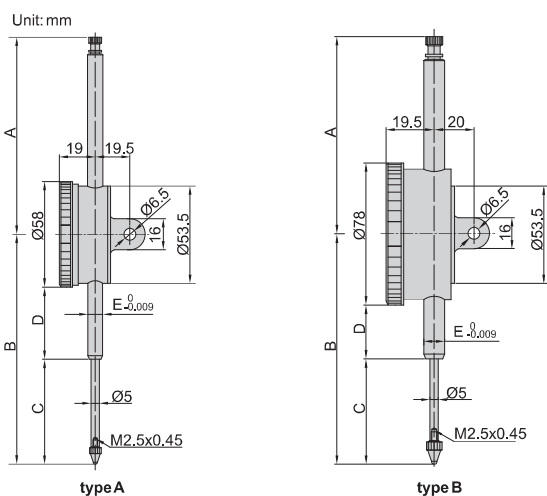

							(mm)
Code	Type	A	B	C	D	E	
2309-30	A	37.5	89.5	40.9	19.5	Ø8	
2309-30F	A	37.5	89.5	40.9	19.5	Ø8	
2309-50	A	108.3	126.2	57.7	39.5	Ø8	
2309-50D	B	108.3	126.2	57.7	29.5	Ø8	
2309-80	A	138.4	168.4	88	51.3	Ø8	
2309-80D	B	138.4	168.4	88	41.3	Ø8	
2309-100D	B	167.6	207.8	108	60.8	Ø10	

Code	Range	Graduation	Type	Accuracy	Hysteresis	Range/rev	Dial reading	Remark
2309-30*	30mm	0.01mm	A	35µm	7µm	1mm	0-100	lug back
2309-30F*	30mm	0.01mm	A	35µm	7µm	1mm	0-100	flat back
2309-50*	50mm	0.01mm	A	40µm	8µm	1mm	0-100	flat back with spare lug back
2309-50D*	50mm	0.01mm	B	40µm	8µm	1mm	0-100	flat back with spare lug back
2309-80	80mm	0.01mm	A	50µm	9µm	1mm	0-100	flat back with spare lug back
2309-80D	80mm	0.01mm	B	50µm	9µm	1mm	0-100	flat back with spare lug back
2309-100D	100mm	0.01mm	B	50µm	9µm	1mm	0-100	flat back with spare lug back

Note: 1) 2309-80, 2309-80D and 2309-100D can only be used vertically
 2) 2309-100D is supplied with stem clamp Ø10mm for magnetic stands (code 6200-60, 6201-60, 6202-80, 6202-100)
 3) 2309-30 and 2309-30F can not accept optional backs (page 132)

* Supplied with manufacturer calibration certificate

INCH DIAL INDICATOR

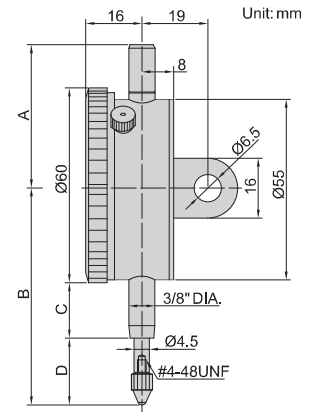

- Supplied with limit pointers and bezel clamp
 - Optional accessory: backs (page 132)
- 2307-1**

(mm)

Code	Range	Graduation	Accuracy		Range/rev	Dial reading	Remark	A	B	C	D
			First 2,5 Rev	Overall							
2307-025*	0.25"	0.001"	±0.001"	±0.001"	0.1"	0-100	lug back	46	75	20	25
2307-05*	0.5"	0.001"	±0.001"	±0.002"	0.1"	0-100	lug back	46	75	20	25
2307-1*	1"	0.001"	±0.001"	±0.002"	0.1"	0-100	lug back	46	85	20	35
2307-2*	2"	0.001"	±0.001"	±0.004"	0.1"	0-100	lug back	111	139	50	59

* Supplied with manufacturer calibration certificate

ONE REVOLUTION PRECISION DIAL INDICATOR



2885-008

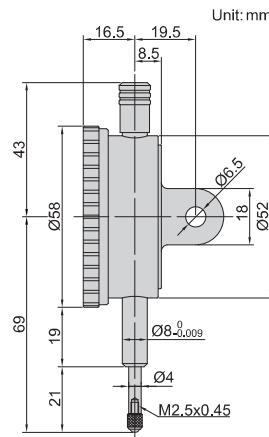

SHOCK PROOF

JEWELLED BEARING

- Eliminate the possibility of reading errors due to miscounting
- Shockproof
- Jeweled bearing
- Free stroke: 4.5mm
- With limit pointers
- Optional accessory: backs (page 132), contact points (page 128~131), lifting lever(code 6289-150)

lifting lever (optional)

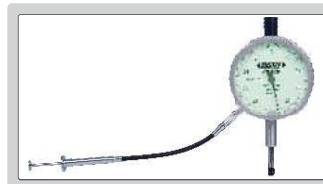

lever device

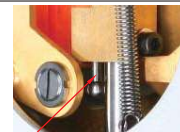

Within the measuring range, the spindle is in contact with the lever



When the measuring range is exceeded, the spindle leaves the lever

Code	Range	Graduation	Accuracy	Hysteresis	Range/rev	Dial reading	Remark
2885-008*	0.08mm	0.001mm	3µm	1.5µm	1mm	40-0-40	lug back
2885-008F*	0.08mm	0.001mm	3µm	1.5µm	1mm	40-0-40	flat back

* Supplied with manufacturer calibration certificate



SHOCK PROOF

ONE REVOLUTION COMPACT DIAL INDICATOR



2884-08

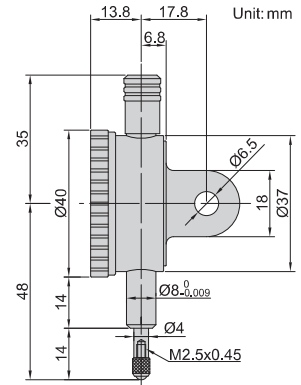

- Eliminate the possibility of reading errors due to miscounting
- Shockproof
- Free stroke: 4mm
- With limit pointers
- Optional accessory: backs (page 132), contact points (page 128~131)

Code	Range	Graduation	Accuracy	Hysteresis	Range/rev	Dial reading	Remark
2884-08 *	0.8mm	0.01mm	9µm	3µm	1mm	40-0-40	lug back
2884-08F *	0.8mm	0.01mm	9µm	3µm	1mm	40-0-40	flat back

* Supplied with manufacturer calibration certificate



SHOCK PROOF

ONE REVOLUTION DIAL INDICATOR



2882-08

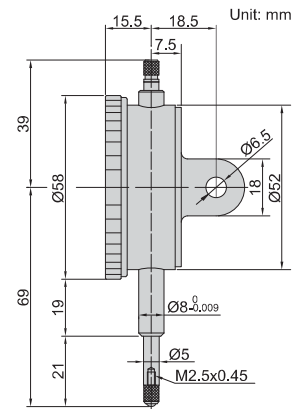

- Eliminate the possibility of reading errors due to miscounting
- Shockproof
- Free stroke: 7mm
- With limit pointers
- Optional accessory: backs (page 132), contact points (page 128~131)

Code	Range	Graduation	Accuracy	Hysteresis	Range/rev	Dial reading	Remark
2882-08 *	0.8mm	0.01mm	9µm	3µm	1mm	40-0-40	lug back
2882-08F *	0.8mm	0.01mm	9µm	3µm	1mm	40-0-40	flat back

* Supplied with manufacturer calibration certificate

BALL POINT



6282-0101

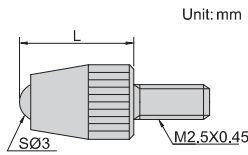

Code	Material of measuring face	L (mm)
6282-0101	carbide	7.3
6282-0103	ceramic	7.3
6282-0104	carbide	8.3
6282-0106	carbide	12.1
6282-0107	carbide	14
6282-0108	carbide	15
6282-0109	ceramic	15
6282-0110	carbide	17
6282-0111	carbide	19.3
6282-0112	carbide	20
6282-0113	ceramic	20
6282-0114	carbide	22
6282-0115	carbide	25
6282-0116	ceramic	25
6282-0117	carbide	30
6282-0118	ceramic	30



6282-0301

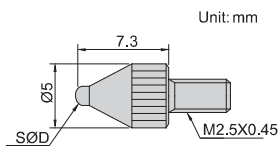

Code	Material of measuring face	SØD (mm)
6282-0301	steel	1
6282-0302	carbide	1.5
6282-0303	carbide	1.8
6282-0304	carbide	2.5
6282-0305	carbide	4

SHELL TYPE POINT



6282-0202

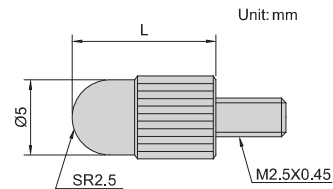

Code	Material of measuring face	L (mm)
6282-0202	steel	5
6282-0203	steel	10
6282-0205	steel	15
6282-0207	steel	20
6282-0208	steel	25
6282-0210	steel	30

SPHERICAL POINT



6282-0401

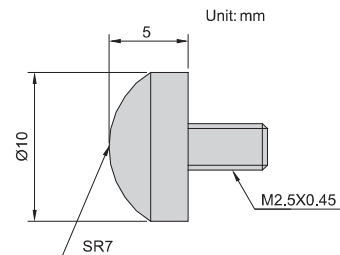

Code	Material of measuring face
6282-0401	steel

CONICAL POINT



6282-0601

Unit: mm

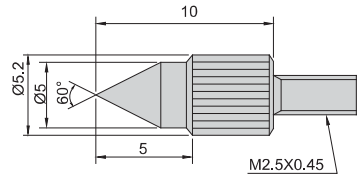

6282-0801

Unit: mm

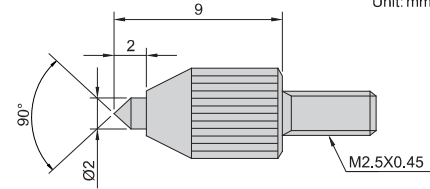

6282-0701

Unit: mm

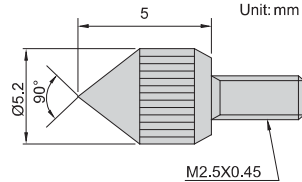

6282-0901

Unit: mm

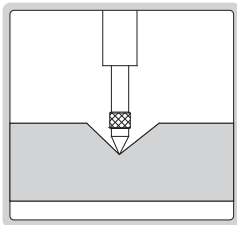
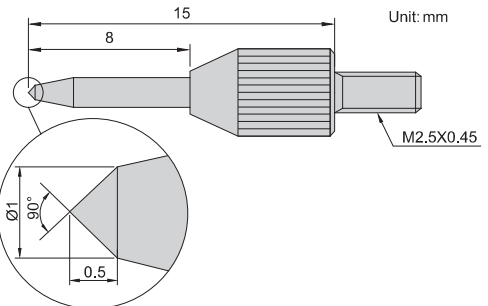

Code	Material of measuring face
6282-0601	steel
6282-0701	steel
6282-0801	steel
6282-0901	steel

FLAT POINT



6282-1101

Unit: mm

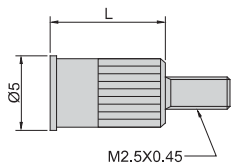

6282-1201

Unit: mm

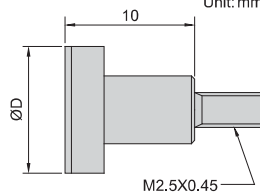

6282-1301

Unit: mm

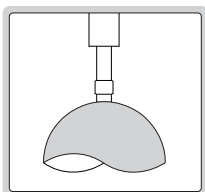
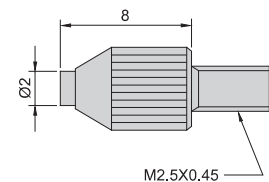

Code	Material of measuring face	L (mm)
6282-1101	steel	8
6282-1102	steel	10

Code	Material of measuring face	ØD (mm)
6282-1201	steel	10
6282-1202	steel	15
6282-1203	steel	20
6282-1204	steel	25
6282-1205	steel	30

Code	Material of measuring face
6282-1301	carbide

NEEDLE POINT

(mm)

Code	Material of measuring face	ØD	L
6282-1701	steel	0.45	3
6282-1702	steel	0.45	5
6282-1703	carbide	1	3
6282-1704	carbide	1	5
6282-1705	carbide	1	8
6282-1706	carbide	1	10
6282-1707	carbide	1	20
6282-1708	carbide	1	40
6282-1709	carbide	1.5	5
6282-1710	carbide	1.5	10
6282-1711	carbide	1.5	13
6282-1712	carbide	1.5	20
6282-1713	carbide	1.5	40
6282-1714	carbide	2	8
6282-1715	carbide	2	18
6282-1716	carbide	2	28
6282-1717	carbide	2	40



6282-1711



6282-1601

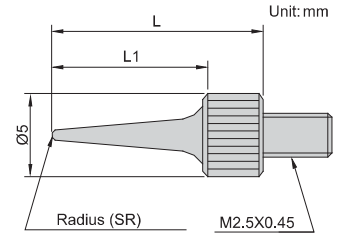
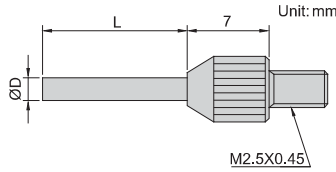

(mm)

Code	Material of measuring face	L1	L	SR
6282-1601	steel	11	15	0.4
6282-1602	steel	13	17	0.2
6282-1603	steel	21	25	0.4
6282-1604	steel	31	35	0.4

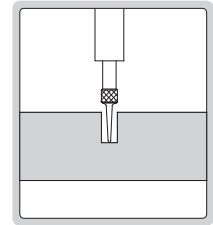

KNIFE EDGE POINT



6282-1001

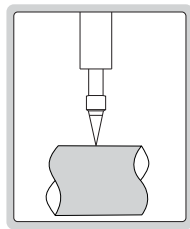
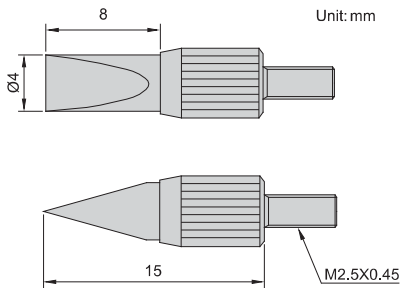

Code	Material of measuring face
6282-1001	steel

BLADE POINT



6282-1801

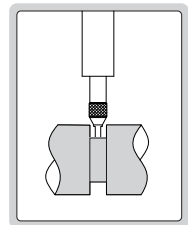
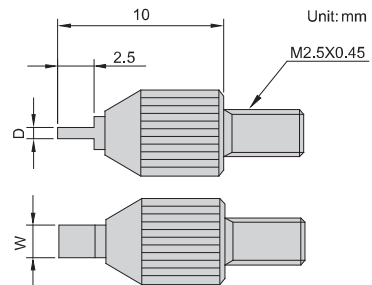

(mm)

Code	Material of measuring face	D	W
6282-1801	steel	0.4	2
6282-1802	steel	0.6	2
6282-1803	steel	1	4

ROLLER POINT

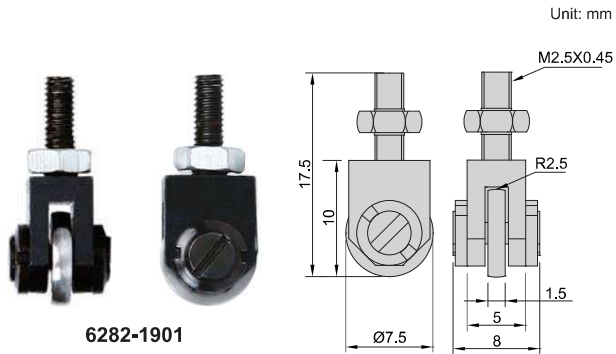

Code	Material of measuring face
6282-1901	steel

EXTENSION ROD

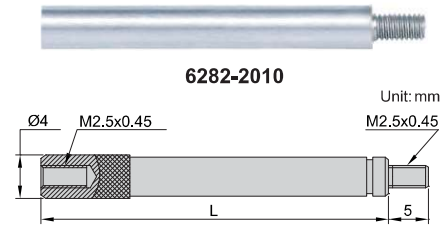

Code	Material	L	Code	Material	L
6282-2001	steel	10	6282-2010	steel	55
6282-2002	steel	15	6282-2011	steel	60
6282-2003	steel	20	6282-2012	steel	65
6282-2004	steel	25	6282-2013	steel	70
6282-2005	steel	30	6282-2014	steel	75
6282-2006	steel	35	6282-2015	steel	80
6282-2007	steel	40	6282-2016	steel	90
6282-2008	steel	45	6282-2017	steel	100
6282-2009	steel	50			



Code	Material of measuring face
6282-S6	steel

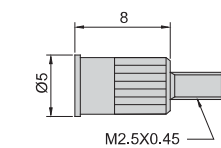

Flat Point

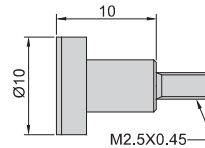

Flat Point

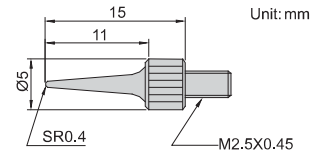

Needle Point

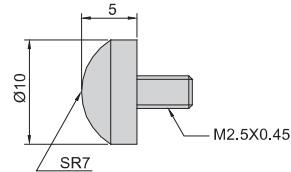

Spherical Point

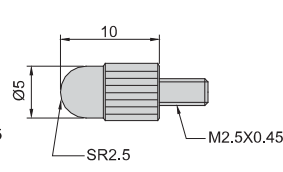

Shell Type Point

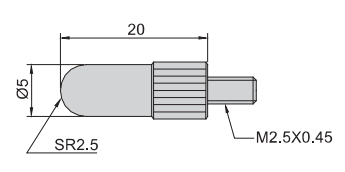

Shell Type Point

LIFTING LEVER



- The lifting cable permits quick lifting of the spindle

Code
6289-150

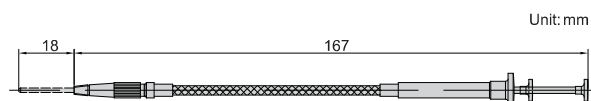

LUG BACK

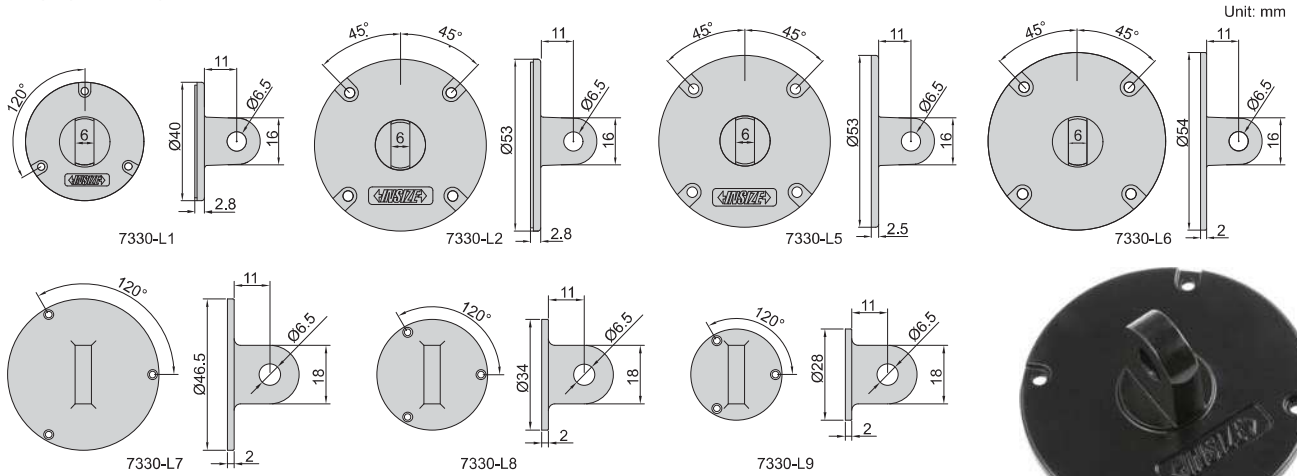

Unit: mm

Code	For digital/dial indicators	Page
7330-L1	2311	118
	2308	119
	2309 (except 2309-30, 2309-30F)	125
7330-L2	2310	124
	2313	117
	2314	120
	2329-10	123

Code	For digital/dial indicators	Page
7330-L5	2103	113
	2104	113
	2108	116
	2112	114
	2113	116
	2115	115
7330-L6	2307	126
	2318	123

Code	For digital/dial indicators	Page
7330-L7	2830	117
	2882	127
	2883	120
	2888	122
	2889	124
	2892	119
7330-L8	2884	127
	2887	118
7330-L9	2886	118



7330-L2



7330-L8

FLAT BACK

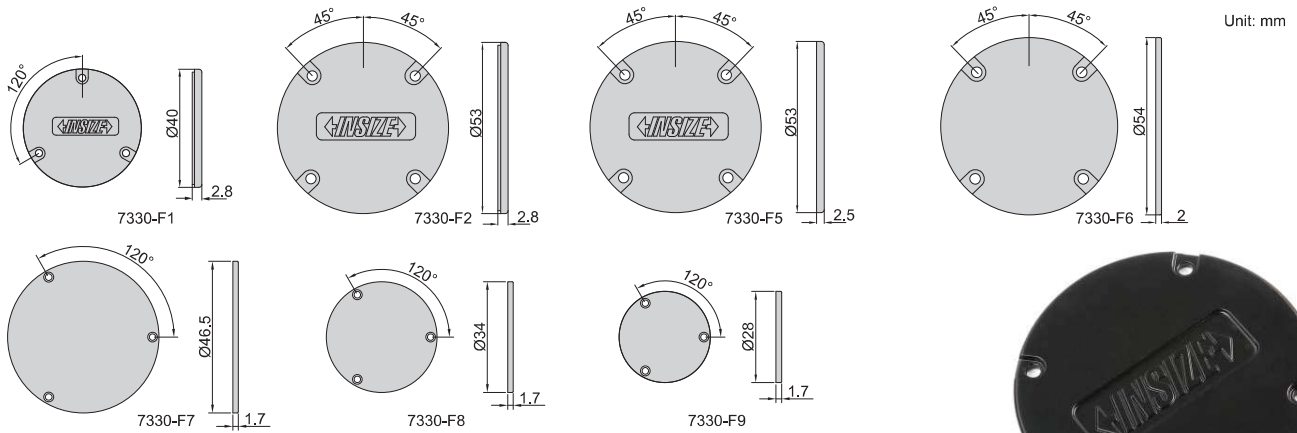

Unit: mm

Code	For digital/dial indicators	Page
7330-F1	2311	118
	2308	119
	2309 (except 2309-30, 2309-30F)	125
7330-F2	2310	124
	2313	117
	2314	120
	2329-10	123

Code	For digital/dial indicators	Page
7330-F5	2103	113
	2104	113
	2108	116
	2112	114
	2113	116
	2115	115
7330-F6	2307	126
	2318	123

Code	For digital/dial indicators	Page
7330-F7	2830	117
	2882	127
	2883	120
	2888	122
	2889	124
	2892	119
7330-F8	2884	127
	2887	118
7330-F9	2886	118



7330-F2



7330-F8



ANTI MAGNETIC
CARBIDE CONTACT POINT

PRECISION DIAL TEST INDICATOR



2897-02

Unit: mm

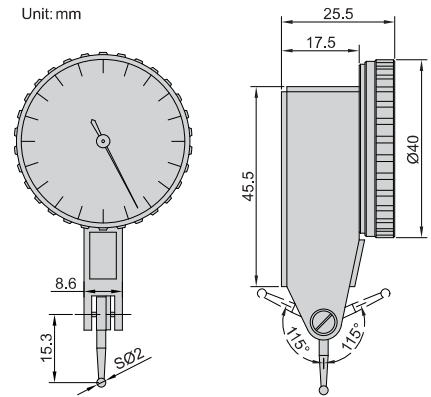

- Ceramic bearing
- Anti magnetic carbide contact point
- Two measuring directions
- Supplied with one clamp: diameter Ø8mm
- Optional accessory: styli (page 138)

Code	Range	Graduation	Accuracy	Hysteresis	Dial reading
2897-02 *	0.2mm	0.001mm	4µm	2µm	0-100-0

* Supplied with manufacturer calibration certificate

clamp

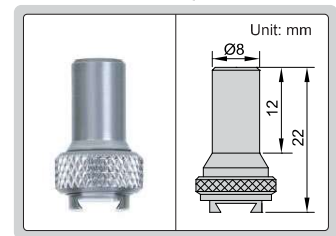

PRECISION DIAL TEST INDICATOR



2880-02

ruby contact point of 2880-02R



Unit: mm

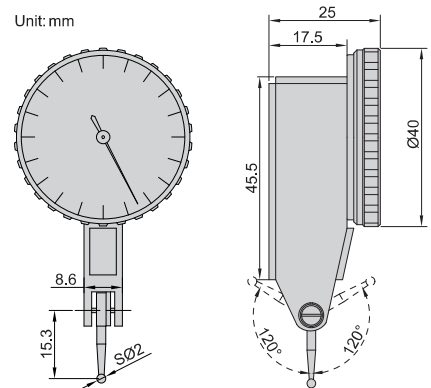

- Ceramic bearing
- Two measuring directions
- Supplied with one clamp: diameter Ø8mm
- Optional accessory: styli (page 138)

Code	Range	Graduation	Accuracy	Hysteresis	Dial reading	Remark
2880-02 *	0.2mm	0.002mm	4µm	2µm	0-100-0	anti magnetic carbide contact point
2880-02R *	0.2mm	0.002mm	4µm	2µm	0-100-0	ruby contact point

* Supplied with manufacturer calibration certificate

clamp

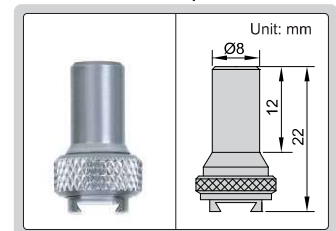

DIAL TEST INDICATOR



ANTI MAGNETIC
CARBIDE CONTACT POINT



2895-08

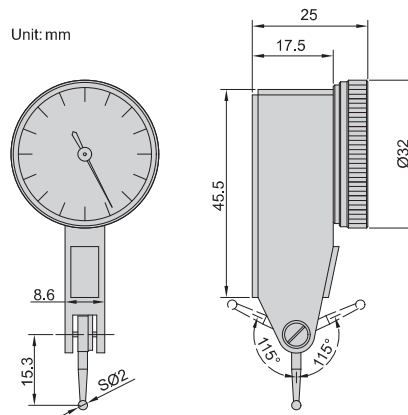

- Ceramic bearing
- Anti magnetic carbide contact point
- Two measuring directions
- Supplied with one clamp: diameter Ø8mm
- Optional accessory: styli (page 138)

Code	Range	Graduation	Accuracy	Hysteresis	Dial reading
2895-08*	0.8mm	0.01mm	13µm	3µm	0-40-0

* Supplied with manufacturer calibration certificate

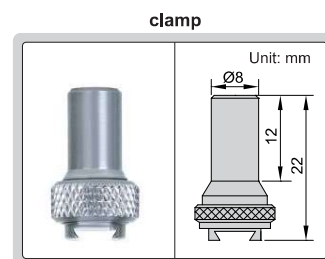

DIAL TEST INDICATOR

JEWELLED
BEARING



2380-08

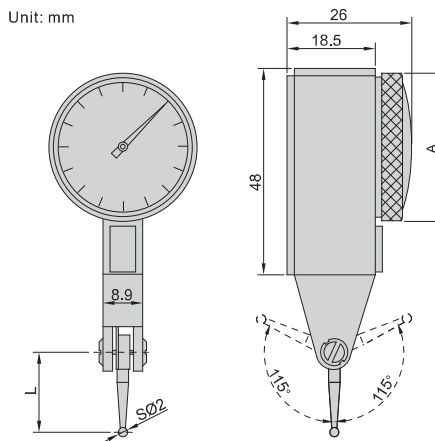

- Jeweled bearing
- Carbide contact point
- Two measuring directions
- Anti magnetic body
- Supplied with two clamps: diameter Ø4mm and Ø8mm
- Optional accessory: styli (page 138)

Code	Range	Graduation	Accuracy	Hysteresis	Dial reading	A	L
2380-08*	0.8mm	0.01mm	13µm	3µm	0-40-0	Ø30	16.5
2381-08*	0.8mm	0.01mm	13µm	3µm	0-40-0	Ø37.5	16.5
2380-02*	0.2mm	0.002mm	6µm	2µm	0-100-0	Ø30	16
2381-02*	0.2mm	0.002mm	6µm	2µm	0-100-0	Ø37.5	16

* Supplied with manufacturer calibration certificate

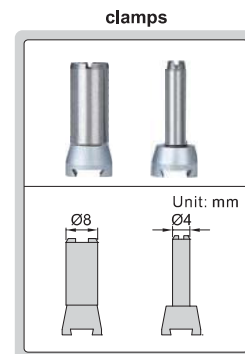



BACK PLUNGER LONG STYLI DIAL TEST INDICATOR

ANTI MAGNETIC
CARBIDE CONTACT POINT



2899-05

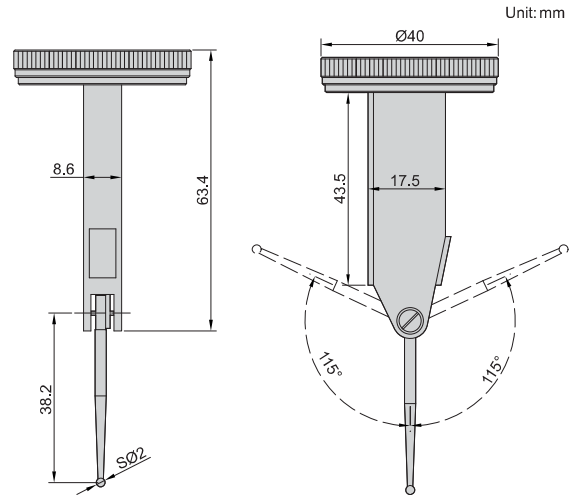

clamp

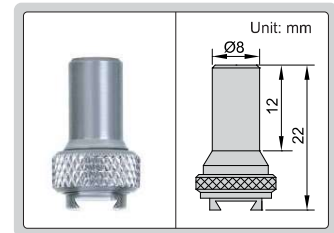

- Ceramic bearing
- Anti magnetic carbide contact point
- Two measuring directions
- Supplied with one clamp: diameter Ø8mm
- Optional accessory: styli (page 138)

Code	Range	Graduation	Accuracy	Hysteresis	Dial reading
2899-05*	0.5mm	0.01mm	13µm	3µm	0-25-0

* Supplied with manufacturer calibration certificate

BACK PLUNGER TYPE DIAL TEST INDICATOR



2398-08

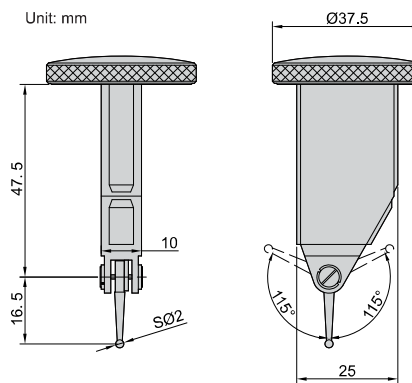

JEWELLED
BEARING

clamps

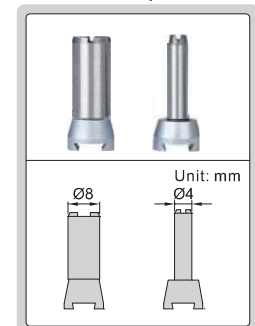

- Jeweled bearing
- Carbide contact point
- Two measuring directions
- Anti magnetic body
- Supplied with two clamps: diameter Ø4mm and Ø8mm
- Optional accessory: styli (page 138)

Code	Range	Graduation	Accuracy	Hysteresis	Dial Reading
2398-08*	0.8mm	0.01mm	13µm	3µm	0-40-0

* Supplied with manufacturer calibration certificate

LONG STYLI DIAL TEST INDICATOR



ANTI MAGNETIC
CARBIDE CONTACT POINT



2896-05

- Ceramic bearing
- Anti magnetic carbide contact point
- Two measuring directions
- Supplied with one clamp: diameter Ø8mm
- Optional accessory: styli (page 138)

Code	Range	Graduation	Accuracy	Hysteresis	Dial reading
2896-05*	0.5mm	0.01mm	13µm	3µm	0-25-0

* Supplied with manufacturer calibration certificate

Unit: mm

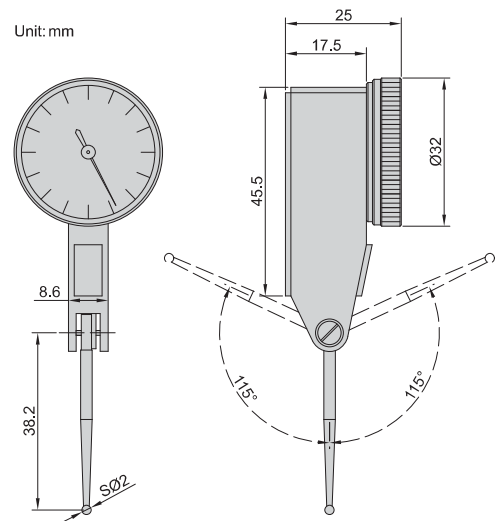

clamp

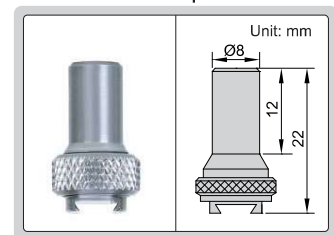

SIDE TYPE DIAL TEST INDICATOR



ANTI MAGNETIC
CARBIDE CONTACT POINT



2898-08

- Ceramic bearing
- Anti magnetic carbide contact point
- Two measuring directions
- Supplied with one clamp: diameter Ø8mm
- Optional accessory: styli (page 138)

Code	Range	Graduation	Accuracy	Hysteresis	Dial reading
2898-08*	0.8mm	0.01mm	13µm	3µm	0-40-0

* Supplied with manufacturer calibration certificate

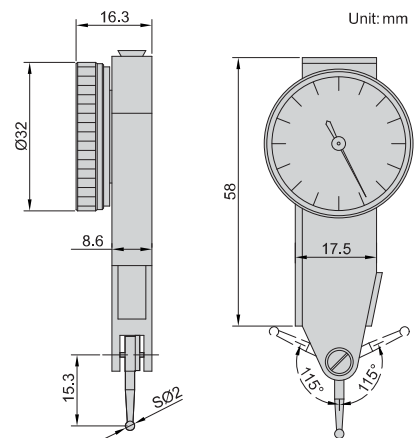

clamp

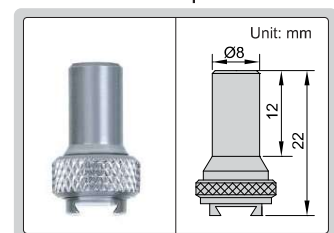

DIAL TEST INDICATOR

JEWELLED BEARING



2399-08

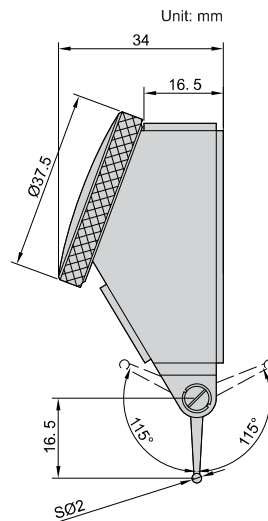

- Jeweled bearing
- Carbide contact point
- Two measuring directions
- Anti magnetic body
- Supplied with two clamps: diameter Ø4mm and Ø8mm
- Optional accessory: styli (page 138)

Code	Range	Graduation	Accuracy	Hysteresis	Dial Reading
2399-08*	0.8mm	0.01mm	13µm	3µm	0-40-0

* Supplied with manufacturer calibration certificate

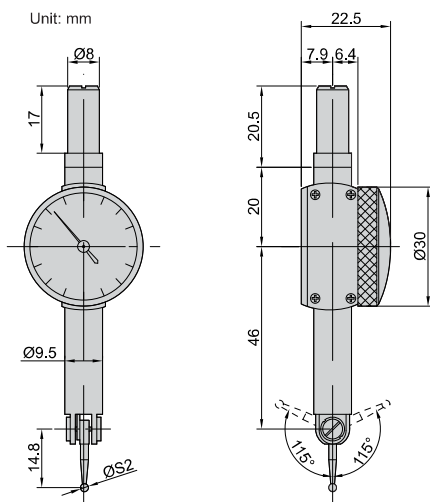
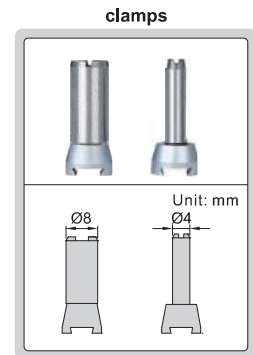

ROUND BODY DIAL TEST INDICATOR

JEWELLED BEARING

- Jeweled bearing
- Carbide contact point
- Adjustable two measuring directions
- Anti magnetic body
- Supplied with two clamps: diameter Ø4mm and Ø8mm
- Optional accessory: styli (page 138)

Code	Range	Graduation	Accuracy	Hysteresis	Dial reading
2391-08*	0.8mm	0.01mm	13µm	3µm	0-40-0

* Supplied with manufacturer calibration certificate

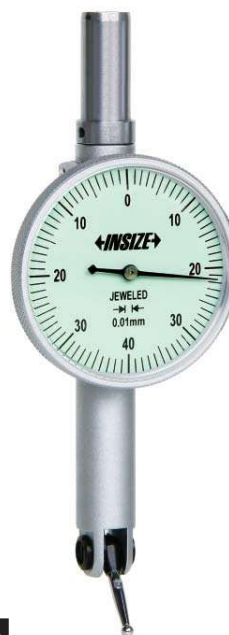

2391-08

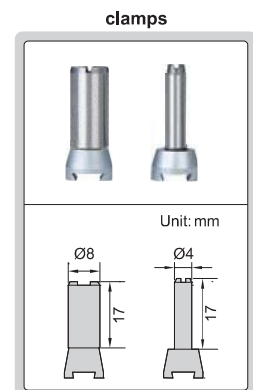

STYLI FOR DIAL TEST INDICATORS

(mm)

Code	For dial test indicator	Material of contact point	L	D
6284-1	2380-08, 2398-08 2381-08, 2399-08	steel	16,5	SØ1
6284-3		carbide	16,5	SØ2
6284-8		carbide	16,5	SØ3
6284-21	2380-02 2381-02	steel	16	SØ1
6284-22		carbide	16	SØ2
6284-23		carbide	16	SØ3
6284-44	2880-02 2880-02R 2895-08 2897-02 2898-08	carbide	15,3	SØ0,4
6284-41		carbide	15,3	SØ1
6284-42		carbide	15,3	SØ2
6284-45		ruby	15,3	SØ2
6284-43		carbide	15,3	SØ3
6284-51		carbide	38,2	SØ1
6284-52	2896-05 2899-05	carbide	38,2	SØ2
6284-55		ruby	38,2	SØ2
6284-53		carbide	38,2	SØ3
6284-71	2391-08	carbide	14,8	SØ2



6284-3

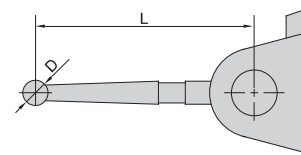

DIAL TEST INDICATOR HOLDER



6293-1



6293-2

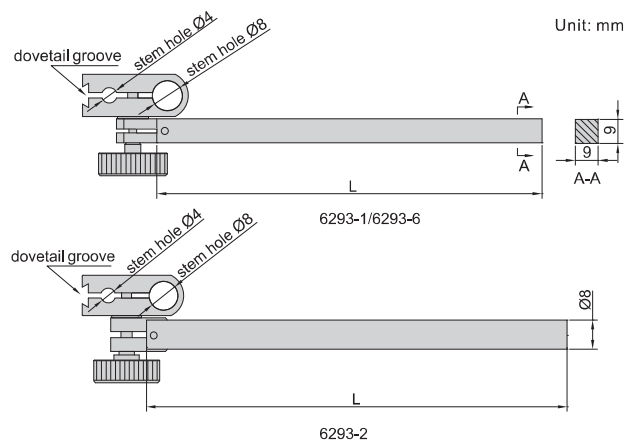

Code	Stem section	Stem length (L)
6293-1	9x9mm	100mm
6293-6	9x9mm	50mm
6293-2	Ø8mm	115mm



DIAL TEST INDICATOR HOLDER



6296-1

- Supplied with fixing spanner

Code

6296-1

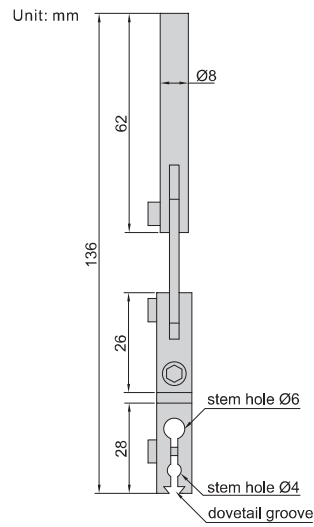

DIAL TEST INDICATOR UNIVERSAL HOLDER



6297-1

Code

6297-1

- Set the indicators at the desired attitude to the workpiece

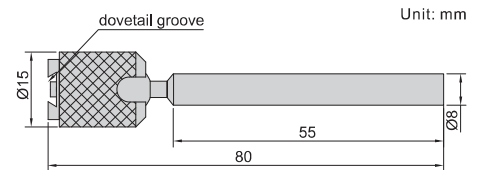

DIAL TEST INDICATOR CENTERING HOLDER



6291-1

Code

6291-1

- Center cylinders or holes on machine tools

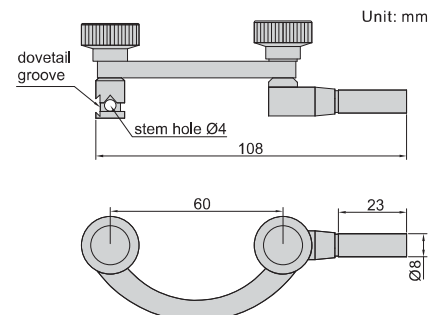

DIAL TEST INDICATOR CENTERING HOLDER



6295-1A

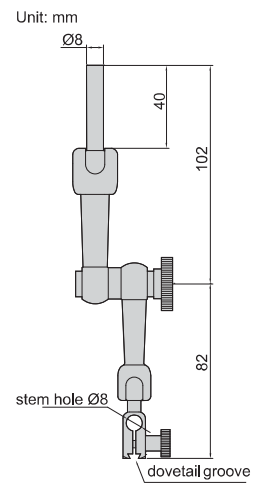

Code

6295-1A

- Center cylinders or holes on machine tools
- Can be used with dial test indicators

INDICATOR CENTERING HOLDER



6294-1A

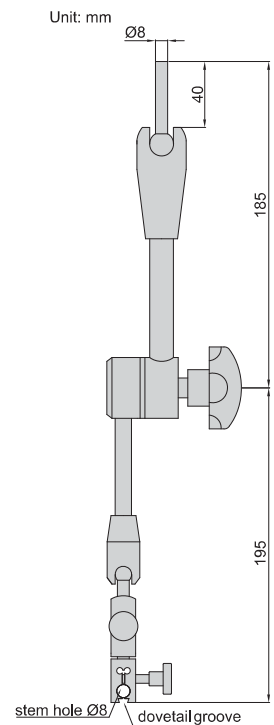

Code

6294-1A

- Center cylinders or holes on machine tools
- Can be used with dial test indicators or dial indicators

UNIVERSAL MAGNETIC STAND

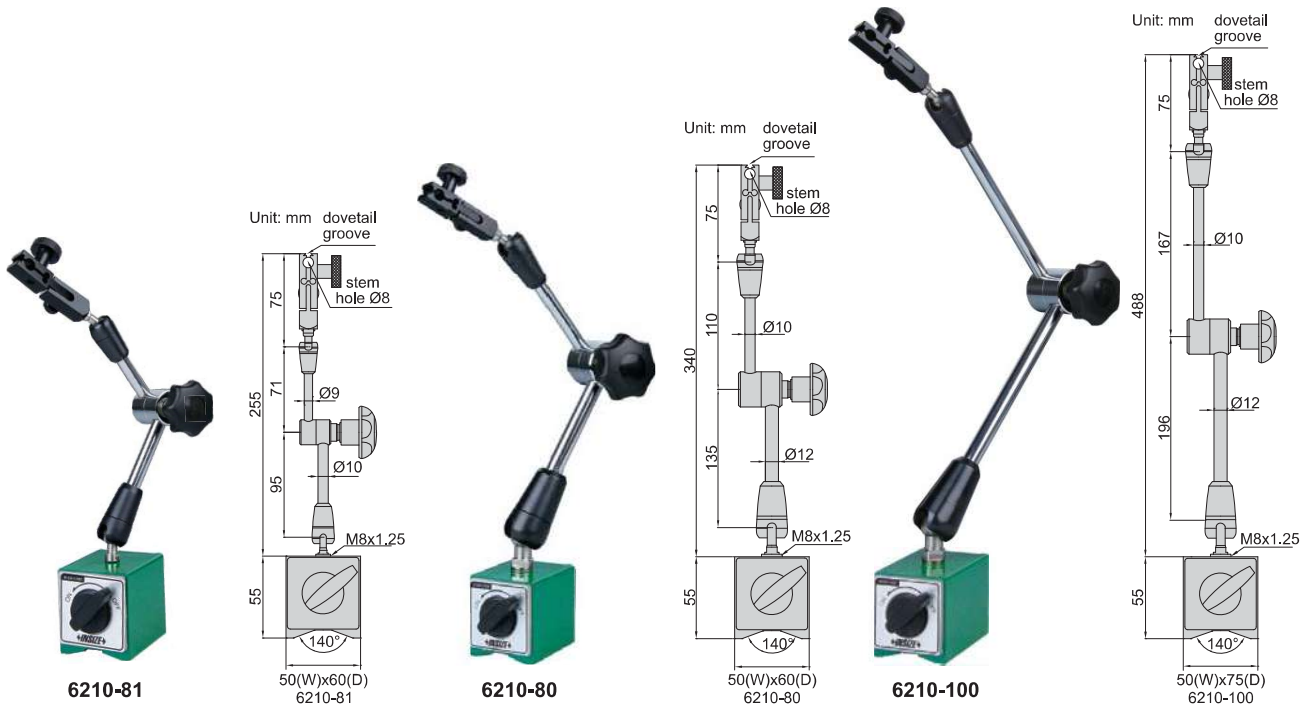

- For digital/dial indicators and dial test indicators

Code	Magnetic force	Applicable holding stem	Remark
6210-81	80kgf	Ø8mm	with fine adjustment and dovetail groove
6210-80	80kgf	Ø8mm	with fine adjustment and dovetail groove
6210-100	100kgf	Ø8mm	with fine adjustment and dovetail groove

MINI MAGNETIC STAND

- For dial test indicators
- With fine adjustment and dovetail groove

Code	Magnetic force	Applicable holding stem
6224-40	40kgf	Ø8mm

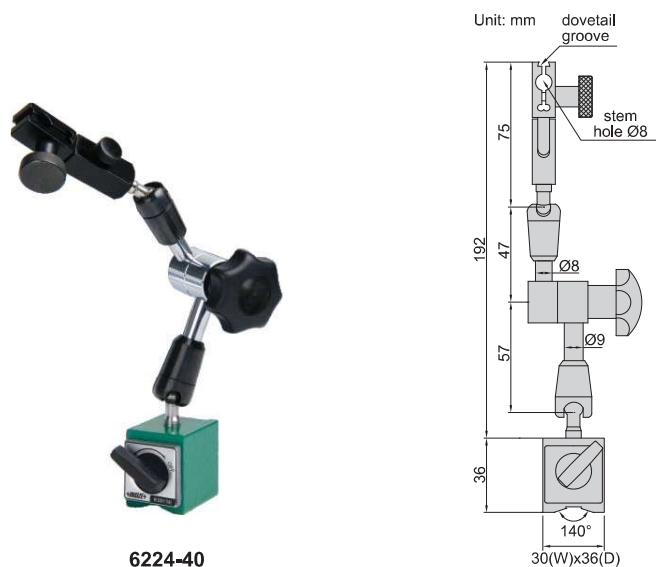

MAGNETIC STAND



Unit: mm

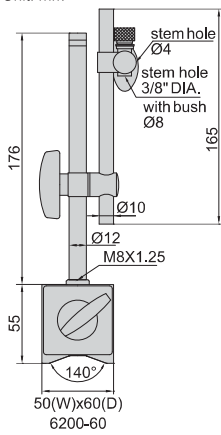

20° adjustable

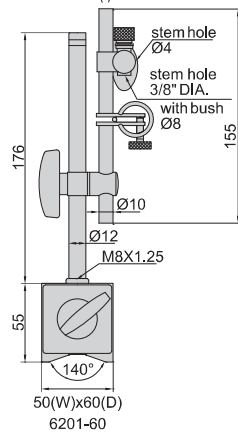

20° adjustable

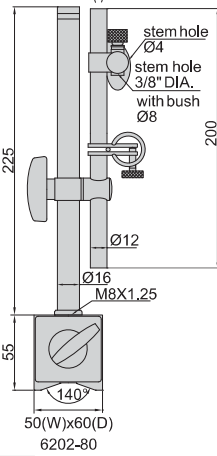

20° adjustable

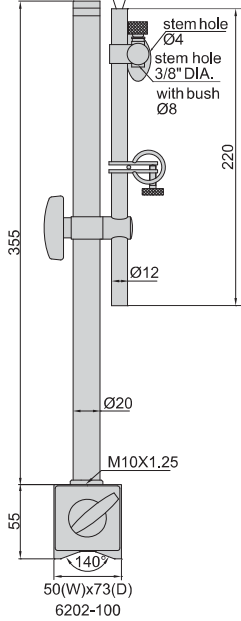

Code	Magnetic force	Applicable holding stem	Remark
6200-60	60kgf	Ø8mm, Ø4mm, 3/8" DIA.	without fine adjustment
6201-60	60kgf	Ø8mm, Ø4mm, 3/8" DIA.	with fine adjustment
6202-80	80kgf	Ø8mm, Ø4mm, 3/8" DIA.	with fine adjustment
6202-100	100kgf	Ø8mm, Ø4mm, 3/8" DIA.	with fine adjustment

■ For digital/dial indicators and dial test indicators

MINI MAGNETIC STAND

- For dial test indicators
- With dovetail groove

Code	Magnetic force	Applicable holding stem
6211-10	10kgf	Ø6mm, Ø8mm



6211-10

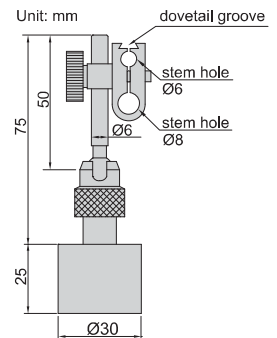

FLEX ARM MAGNETIC STAND

- For dial test indicators

Code	Magnetic force	Applicable holding stem
6207-80A	80kgf	Ø8mm, Ø4mm, 3/8" DIA.

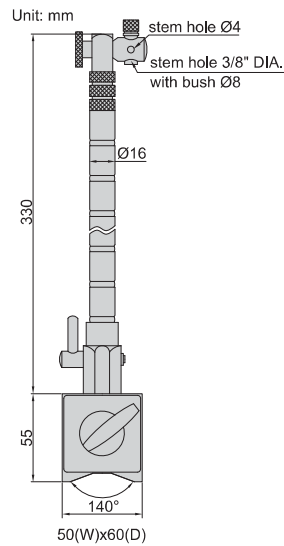

6207-80A

MAGNETIC STAND FOR UNEVEN SURFACE

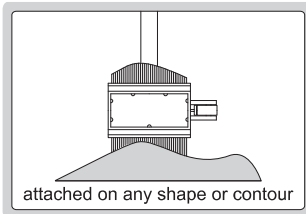

- For digital/dial indicators and dial test indicators
- With fine adjustment

Code	Magnetic force	Applicable holding stem
6215-60	60kgf	Ø8mm, Ø4mm, 3/8" DIA.

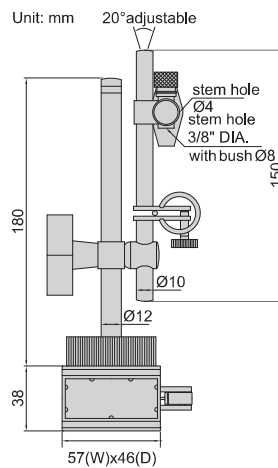

6215-60

UNIVERSAL STAND

- For digital/dial indicators and dial test indicators
- With fine adjustment

Code	Applicable holding stem
6214-A	Ø8mm, Ø4mm, 3/8" DIA.

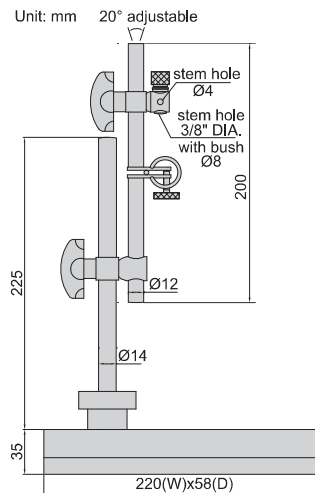

6214-A

GRANITE COMPARATOR STAND



6866-150

- Vertical travel of holder: 150mm
- Fine adjustment range: 2mm

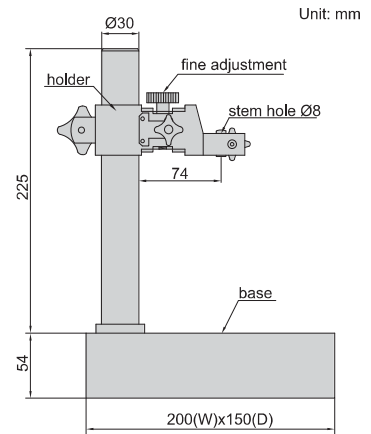

Code	Applicable holding stem	Base
6866-150	Ø8mm	flatness 2.5µm

GRANITE COMPARATOR STAND



6867-250

- Vertical travel of holder: 250mm
- Fine adjustment range: entire stroke

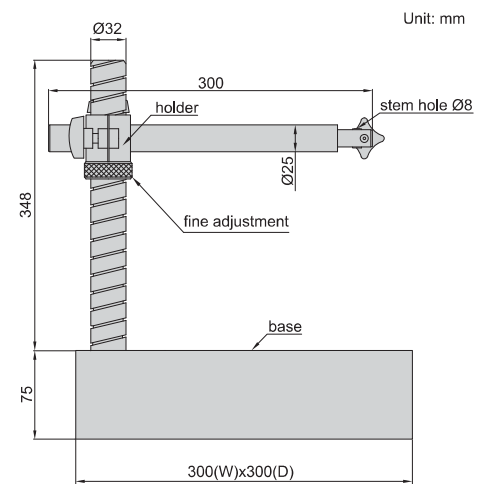

Code	Applicable holding stem	Base
6867-250	Ø8mm	flatness 2.8µm

DIAL GAGE STAND



6863-150

- Vertical travel of holder: 150mm
- Fine adjustment range: 2mm

Code	Applicable holding stem	Anvil
6863-150	Ø8mm	serrated, flatness 1.5µm, hardness HRC60±2

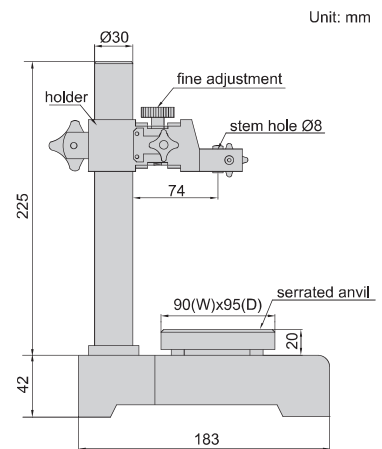

COMPARATOR STAND



6864-250

- Vertical travel of holder: 250mm
- Fine adjustment range: entire stroke

Code	Applicable holding stem	Anvil
6864-250	Ø8mm	serrated, flatness 1.5µm, hardness HRC60±2

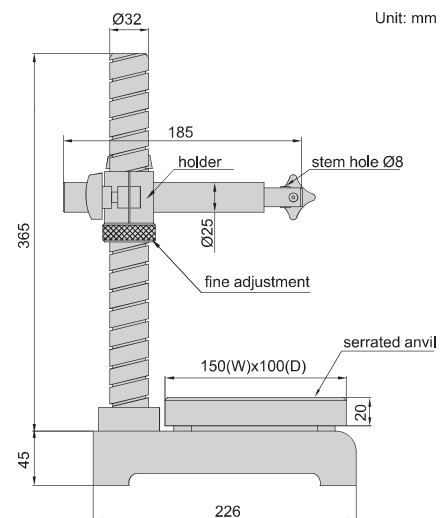

DIAL GAGE STAND



6862-1001



6862-1002

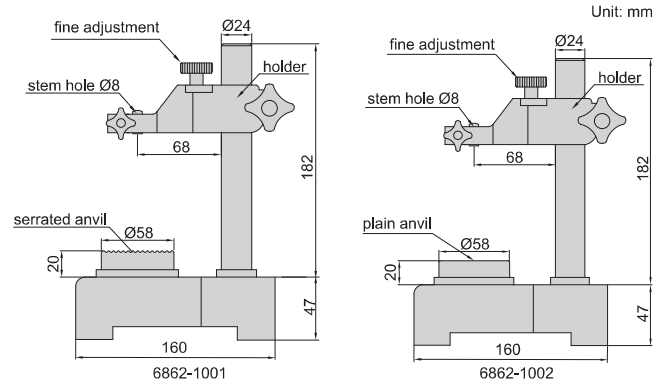

- Vertical travel of holder: 100mm
- Fine adjustment range: 2mm

Code	Applicable holding stem	Anvil
6862-1001	Ø8mm	serrated, flatness 1.5µm, hardness HRC60±2
6862-1002	Ø8mm	plain, flatness 1.5µm, hardness HRC60±2

CONCENTRICITY GAGE



4789-1



4789-3

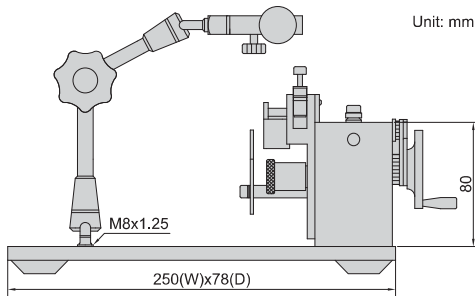

- Accuracy 2µm
- Optional accessory: dial test indicator, mini magnetic stand (code 6224-40)

Code	Applicable diameter
4789-1	Ø3.5mm - 25mm
4789-3	Ø1mm - 25mm

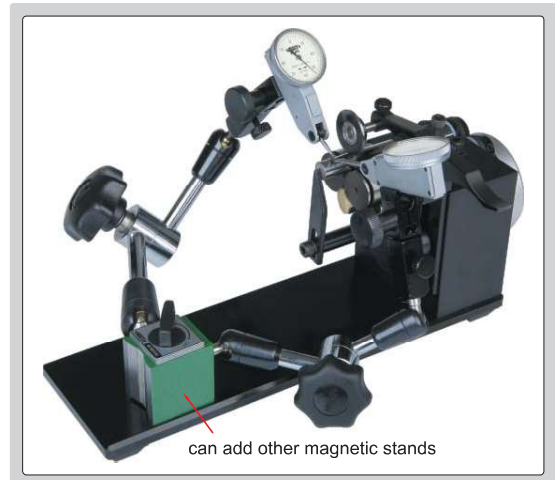

RELATIVE PRODUCT:
SINE BAR
(CODE 4156-)



4157-200

- Check taper or runout of taper bars
- Sine bar accuracy ($\alpha=30^\circ$): ± 5 seconds

Code	Accuracy	Center height (H)	Center distance (L)
4157-200	0,01mm	65mm	200mm

SINE BENCH CENTER

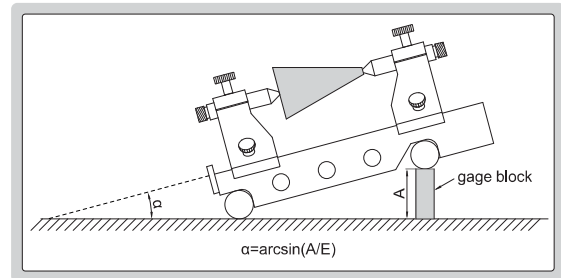
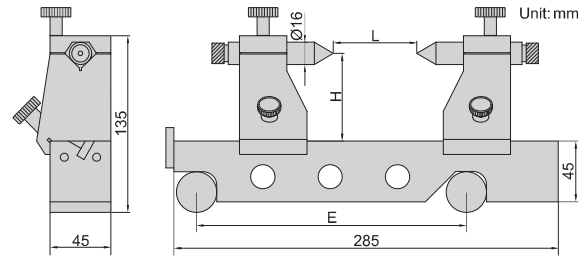

4788-300

- Hardened cast-iron guide surface
- Movable column

BENCH CENTER

HIGH
PRECISION

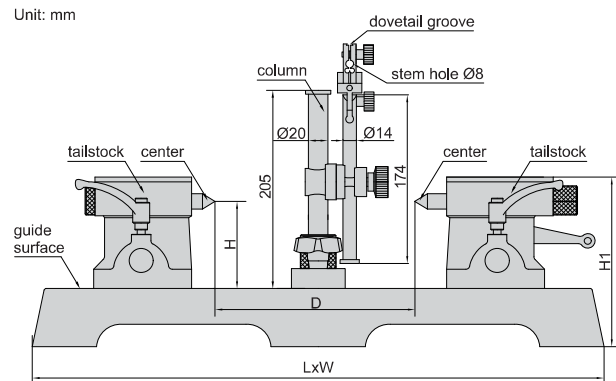

(mm)

Code	Accuracy*	Center height (H)	Distance between two centers(D)	Length (L)	Width (W)	Height (H1)	Taper of center	Weight
4788-300	0,01mm	90	300	590	192	175	MT1	34kg
4788-400	0,01mm	130	400	770	206	241	MT2	66kg
4788-600	0,01mm	130	600	930	220	250	MT2	90kg
4788-600H2	0,01mm	200	600	930	220	325	MT2	105kg
4788-1000	0,01mm	130	1000	1330	220	262	MT2	112kg
4788-1000H2	0,01mm	200	1000	1330	220	337	MT2	125kg
4788-1000H3	0,01mm	300	1000	1330	220	442	MT2	165kg

* The accuracy is the parallelism of the line between two centers to the guide surface

VERTICAL AND HORIZONTAL CENTER BENCH

HIGH PRECISION

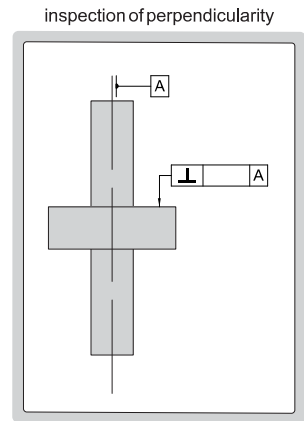
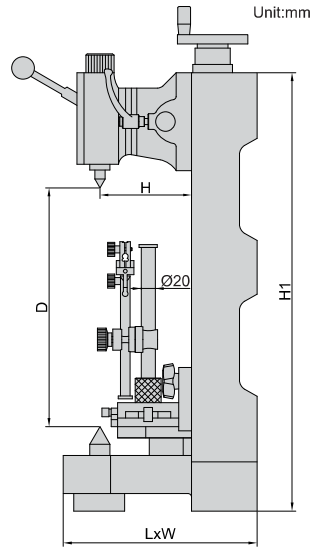
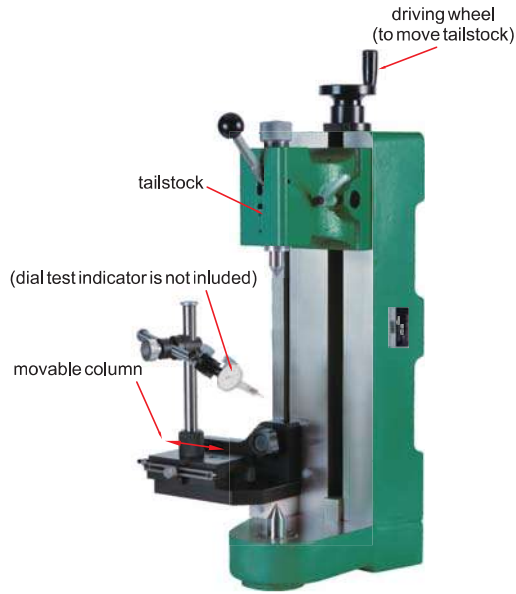

4783-380

- For vertical and horizontal use
- Move tailstock via driving wheel
- To check perpendicularity after cablibrated

Code	Accuracy*	Center height (H)	Distance between two centers(D)	Length (L)	Width (W)	Height (H1)	Taper of upper center	Taper of lower center	Weight
4783-380	0.01mm	130	380	275	198	622	MT2	MT3	80kg

*The accuracy is the parallelism of the line between two centers to the guide surface

BENCH CENTER

V-SLOT FOR CYLINDER Ø5-Ø33MM

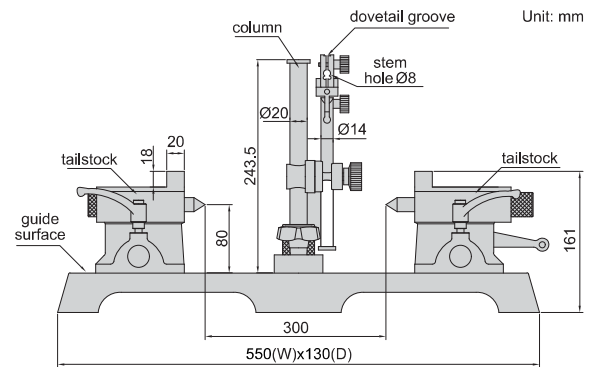
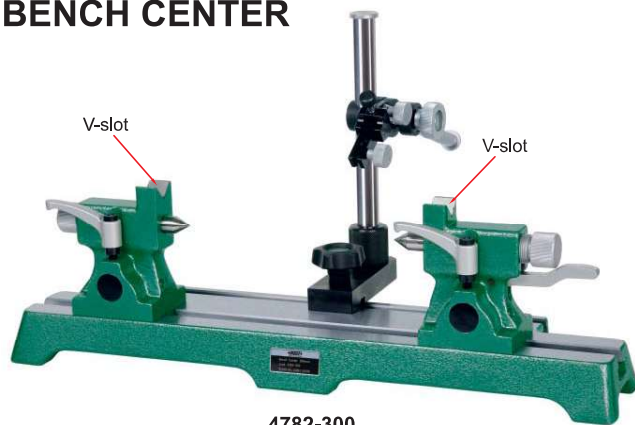

4782-300

- Hardened cast-iron guide surface
- Movable column

Code	Accuracy	Center height	Distance between two centers	Taper of center
4782-300	0.025mm	80	300	MT1